

Afinia Label L701 Color Label Printer with Memject Print Head

Quick Guide



Provided by

MyBinding.com
When Image Matters.

Call Us at 1-800-944-4573

AFINIA

L701 Label Printer

Powered by
memjet®

Quick Setup and Installation Guide

For more detailed information, insert the Installation Disc into the PC and click the **User Guide** button on the Setup Launcher main page.

Unpack:

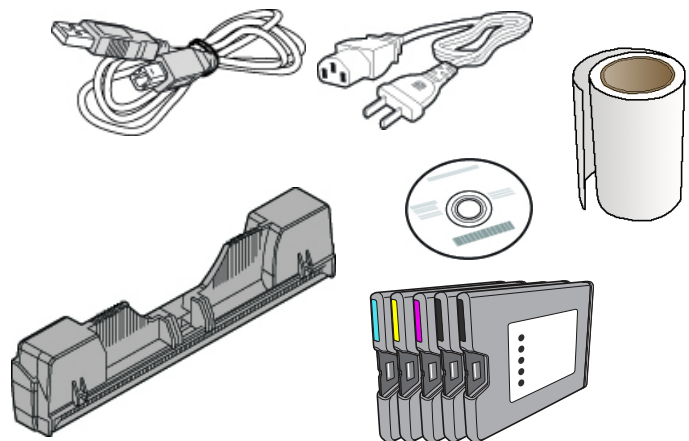
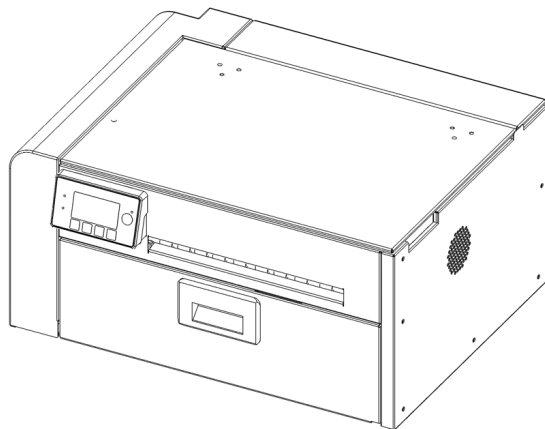

1 Remove tape and packing materials

- a Remove tapes.

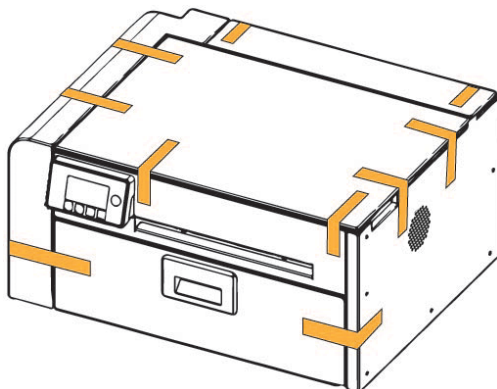

(continued on next page)

MyBinding.com
5500 NE Moore Court
Hillsboro, OR 97124
Toll Free: 1-800-944-4573
Local: 503-640-5920

- (b)** Open top cover and remove tapes and foam.

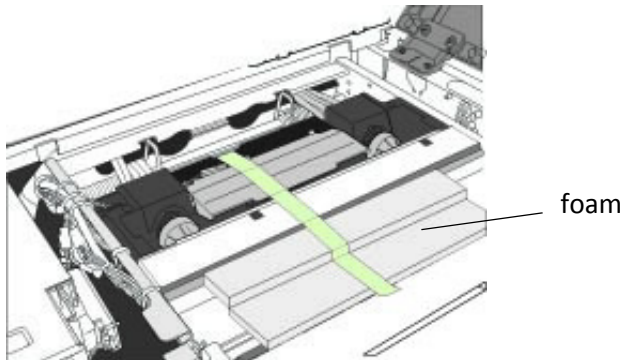

- (c)** Remove cardboard.

Save the packing foam and cardboard!

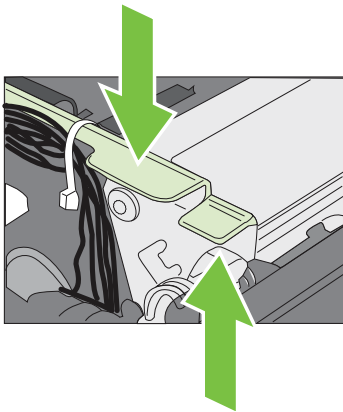

Squeeze latches to open clamshell

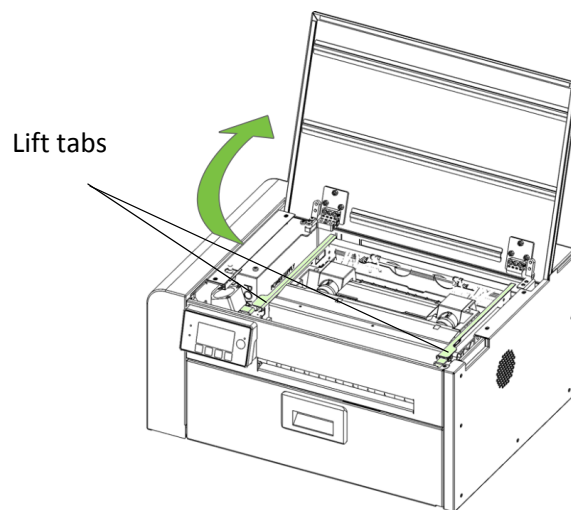

Pull tabs to remove cardboard

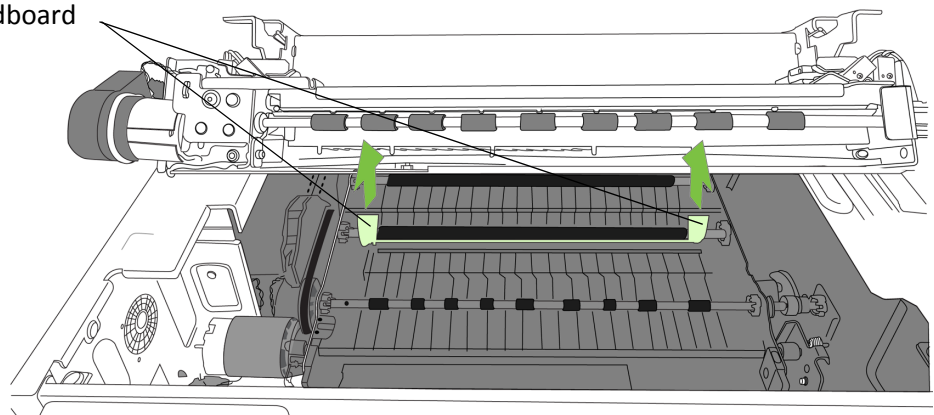

2 Connect power, turn on switch in back

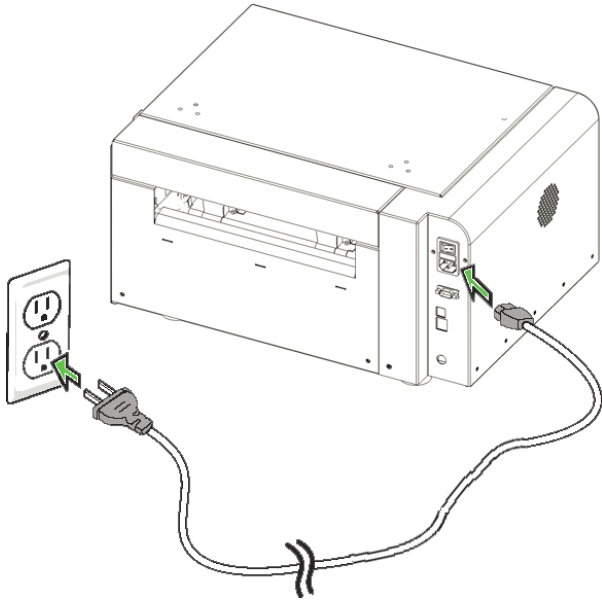

Do not connect the printer to a PC until prompted to do so during the Printer Driver Installation!



Choose display language

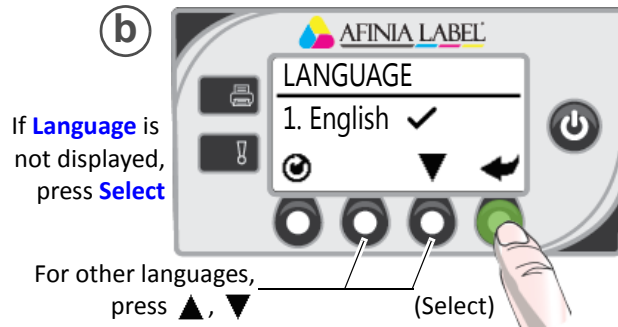
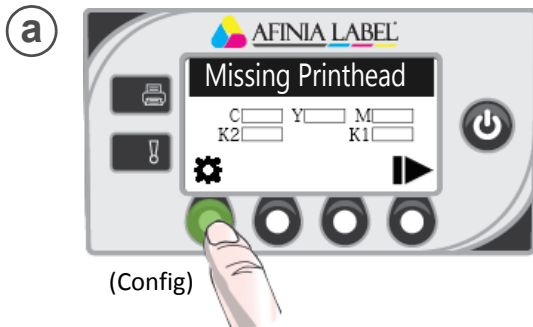

If **Language** is not displayed, press **Select**

For other languages, press ▲, ▼

If Language option is not available, see [Selecting the Security Level](#) in Chapter One of the User's Manual.

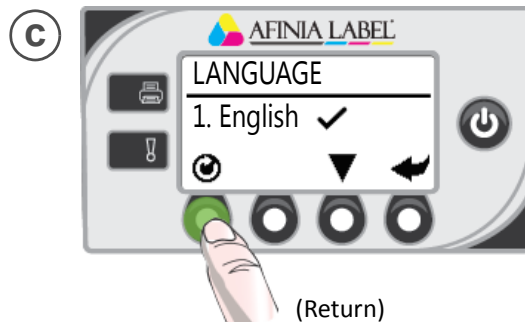

3 Install ink cartridges

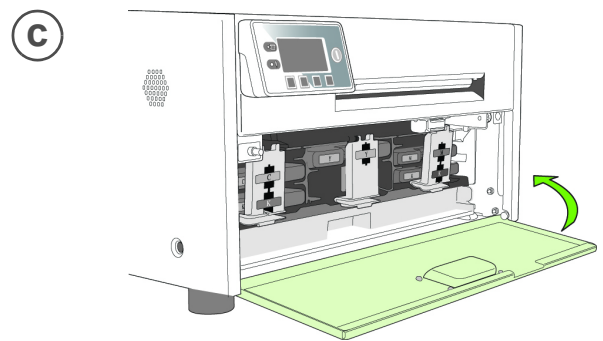
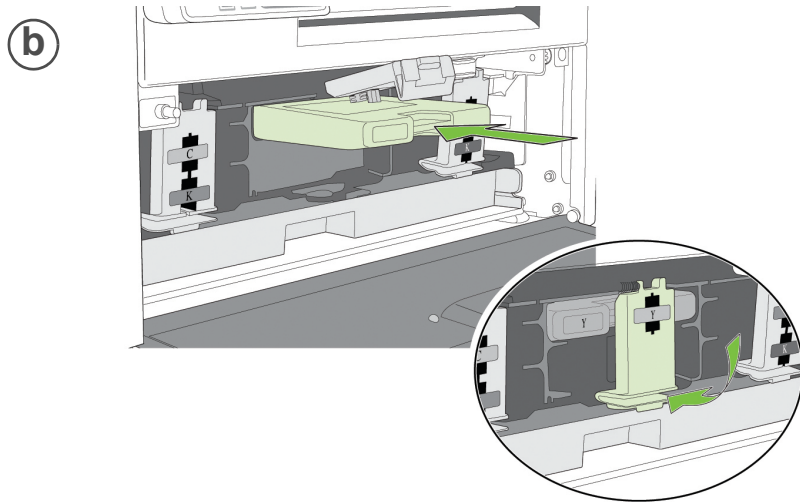
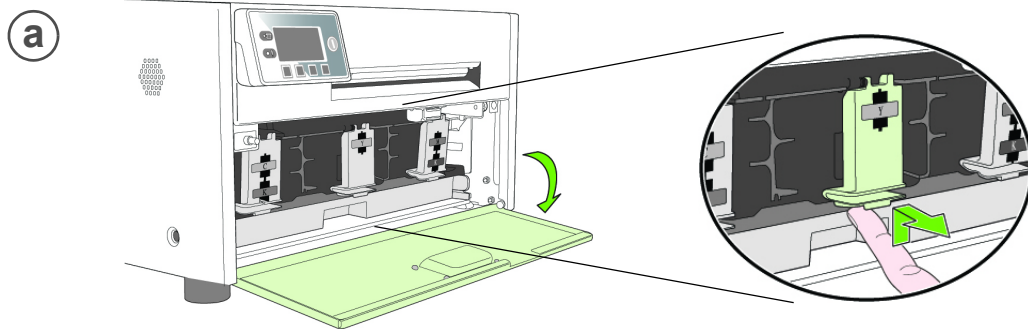
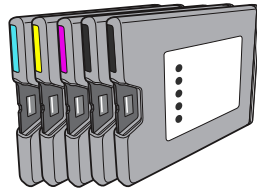

MyBinding.com
5500 NE Moore Court
Hillsboro, OR 97124
Toll Free: 1-800-944-4573
Local: 503-640-5920

4 Install printhead

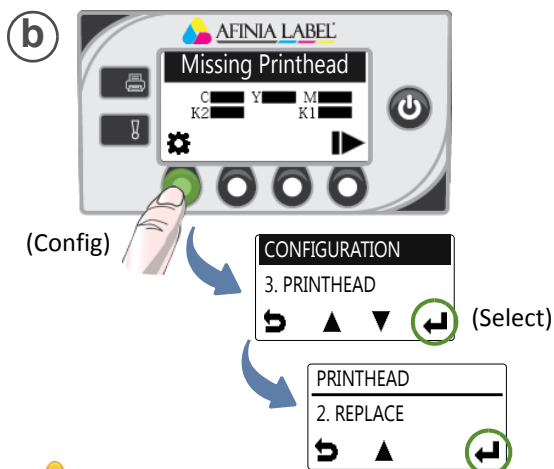
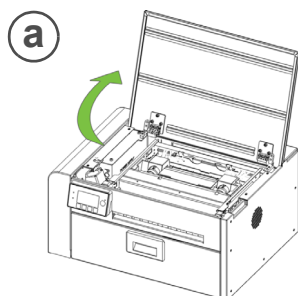

! Wait for printhead latch to be released.

(c) Open printhead latch fully.

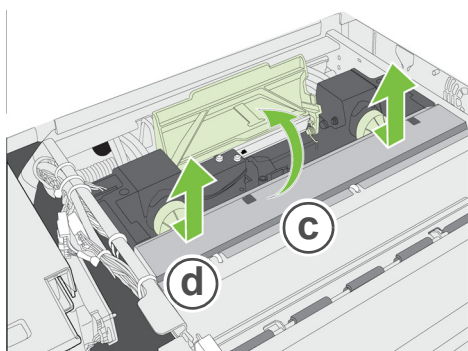

(d) Remove caps.

Do not discard caps!

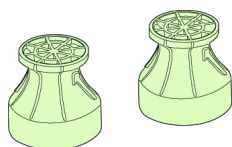

(e) Remove cover from printhead

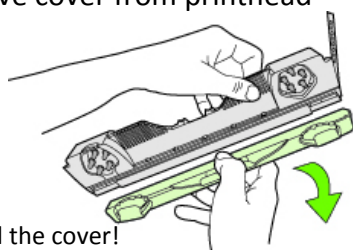

Do not discard the cover!

(f) Slowly remove tape from electrical contacts and nozzles

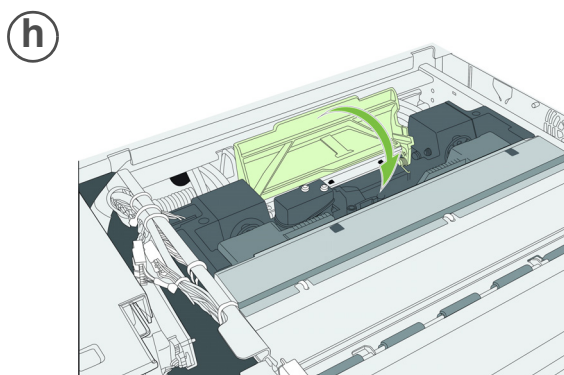
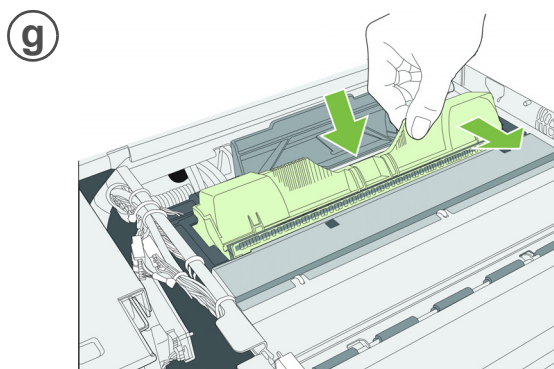
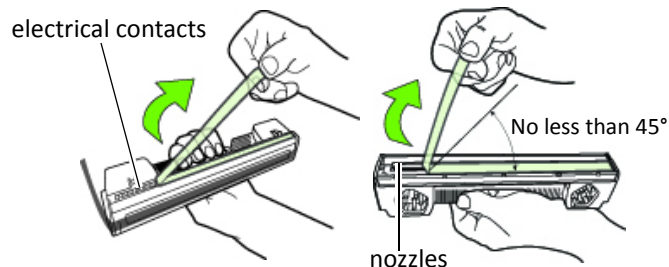

Check that ink is flowing through the tubes on both sides of the printhead.

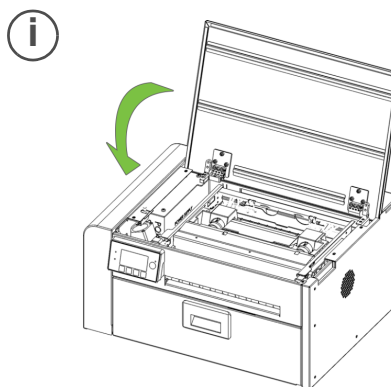

Control Panel will read **Online** when ready

MyBinding.com
5500 NE Moore Court
Hillsboro, OR 97124
Toll Free: 1-800-944-4573
Local: 503-640-5920

5 Load sample media

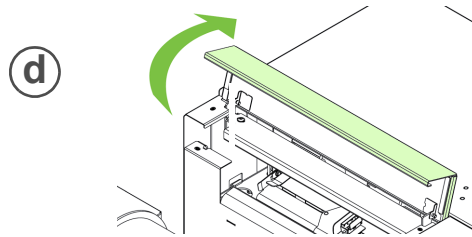
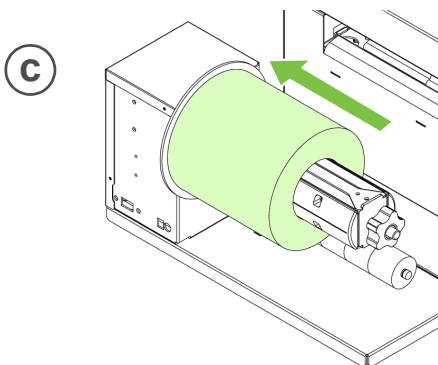
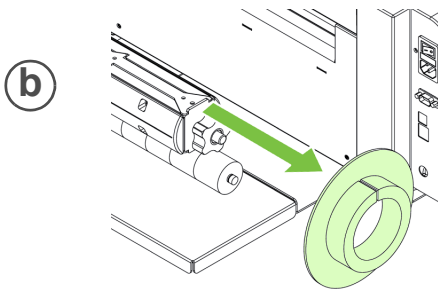
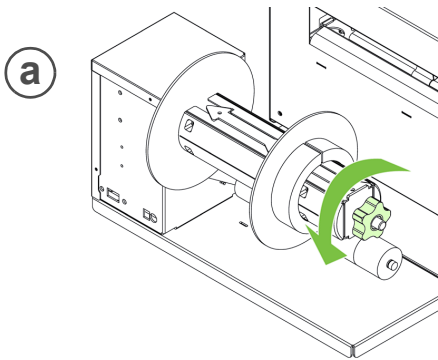
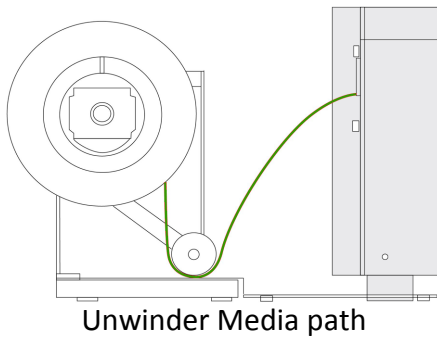

Flat side against media roll.

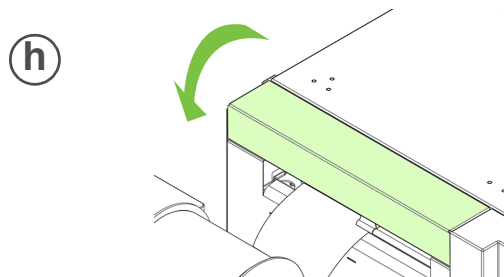
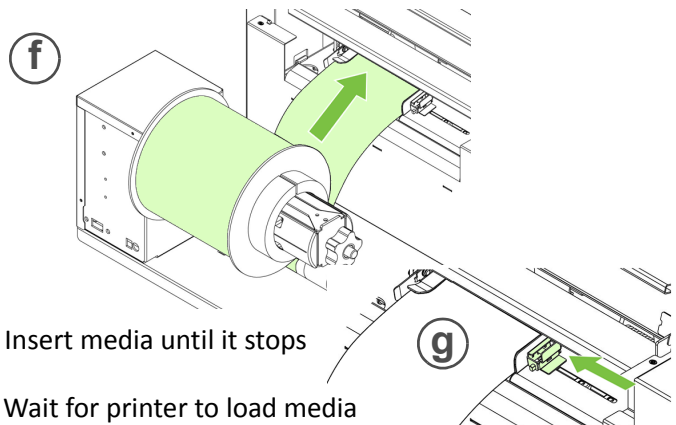
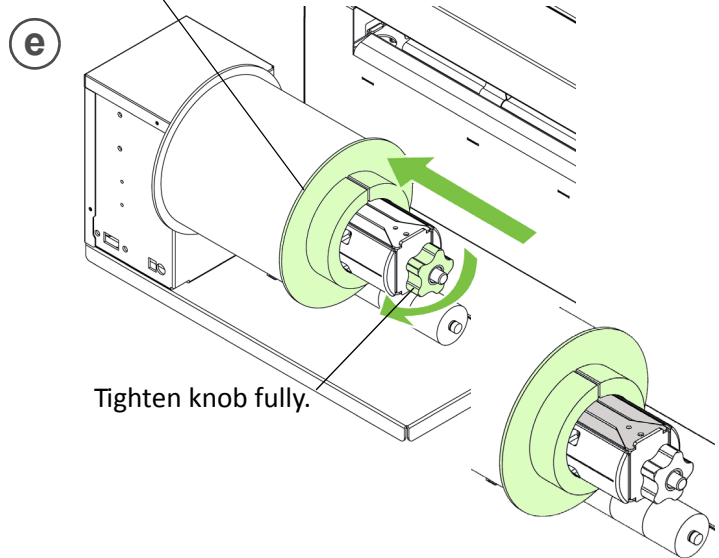

6 Print test label

Requires inter-label gap or continuous media



(Config)

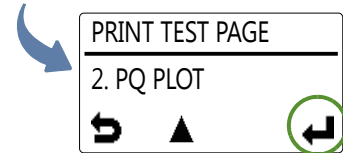
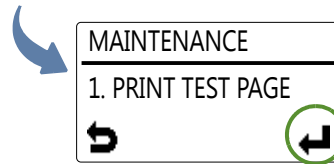
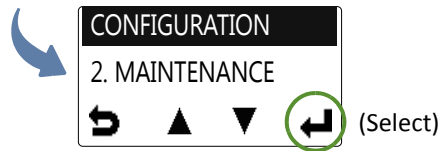

Sample PQ Plot



Top Section:

- Lines are defined with no missing nozzles
- Lines are printed in order: Yellow, Black, Cyan, Black, Magenta
- Vertical dashed lines are straight

Middle Section:

- All yellow, black, cyan, black, magenta lines are printed
- No color mixing on the color bars
- Numbers 1, 3, 5 are visible

Bottom Section:

- Lines are defined with no missing nozzles
- Lines are printed in order: Yellow, Black, Cyan, Black, Magenta

Overall:



- No streaking or smearing

MyBinding.com
5500 NE Moore Court
Hillsboro, OR 97124
Toll Free: 1-800-944-4573
Local: 503-640-5920

7 Install printer driver

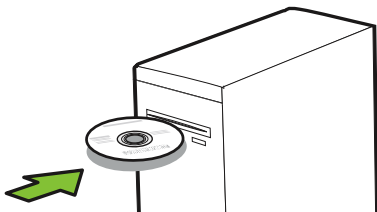

Before installing printer driver, ensure the computer meets minimum system requirements (see [System Requirements](#) in the User Manual Appendix).

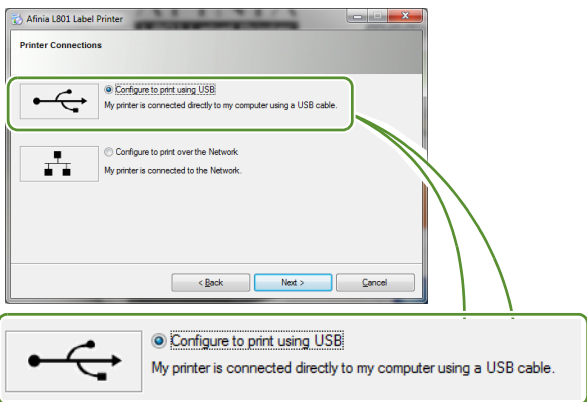
To connect printer to computer using USB

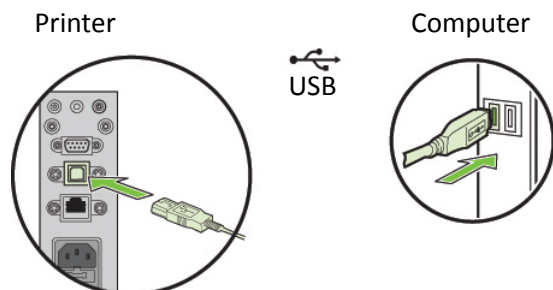
- a**
- 
- b**
- 
- c**
- 
- d** Connect USB cable when prompted.

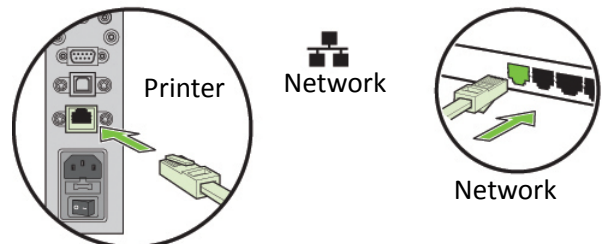
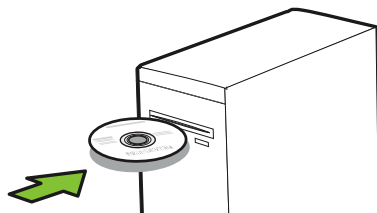

To connect printer to network

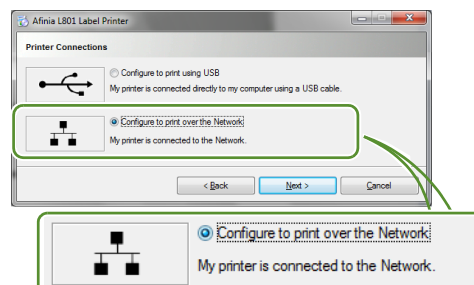
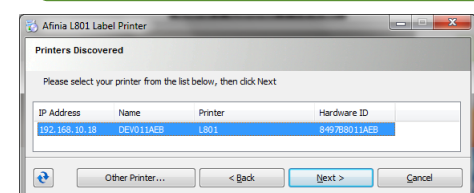
- a** Connect printer to network using Ethernet
- 
- b** If you will be using DHCP to set the IP Address, skip to step c.
To assign the printer a Static IP address, please see [Selecting the Security Level](#) in Chapter One of the User Manual before proceeding to step c.
- c**
- 
- d**
- 
- e**
- 
- 
- | IP Address | Name | Printer | Hardware ID |
|---------------|-----------|---------|--------------|
| 192.168.10.18 | DEVD11AEB | L801 | 849768011AEB |