

Coverbind 5000 / Bindomatic Accel Flex Professional Thermal Binding Machine

Product Spec Sheet



Provided by

MyBinding.com
When Image Matters.

Call Us at 1-800-944-4573

Accel flex

DOCUMENT BINDING HAS
NEVER BEEN EASIER.



The Bindomatic® Accel Flex is a powerful, manually operated binder designed to meet any document format demand, with spine lengths up to fourteen inches. Bind documents as thick as 2 inches, soft covers, hard covers; this binder will bind them all and do it stronger and more effectively than any comparable manual binding system on the market, up to 15 documents per minute.

If you need to remove, replace or add sheets, simply re-heat the binding. With the wide range of Coverbind covers, your business presentations, reports, proposals, statements, manuals etc, will always look and feel as professional as the content and message of your document.

DOCUMENT SIZE

Min: 5 1/2" x 8 1/2" | Max: 14 7/8" x 11"

SYSTEM CAPACITY

Load up to 15 documents per binding cycle (~60 sec) depending on the width of the spine

DOCUMENT SPINE WIDTH

1/16" up to 2"

MACHINE DIMENSIONS

17 9/16" L x 10 3/8" W x 5 1/4" H

MACHINE FINISHING

Metal surface, heating plate with Teflon

MACHINE WEIGHT

12 lbs

POWER SUPPLY

115V, 50/60Hz, 700W, 6.4 amps (maximum)

COVERBIND®
BINDING EFFICIENCY EXPERTS

WWW.MYBINDING.COM

360°
VIEW



Step-by-step, easy to follow instructions are on every Bindomatic Accel Flex.

The slide manually expands and contracts depending on your document size and quantity of covers in a binding cycle.

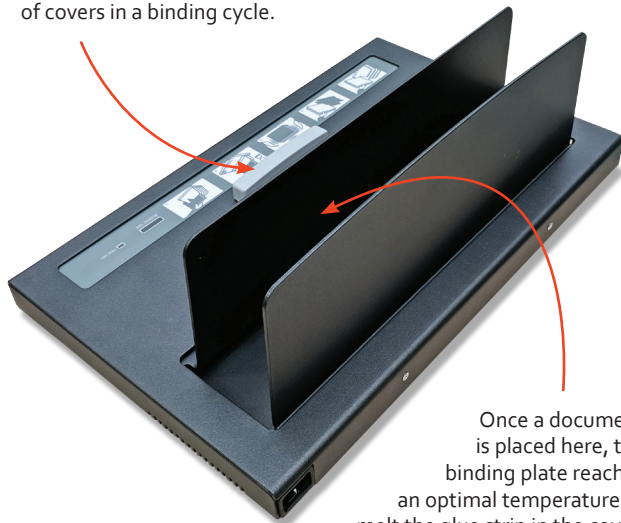

Once a document is placed here, the binding plate reaches an optimal temperature to melt the glue strip in the cover, securely binding your pages.

An indicator light, activated by a Coverbind cover, shows when the heating surface is on.



Timer indicates how long the document needs to stay on the binding plate

HOW IT WORKS



1. Determine spine size using guide on cooling rack.

2. Place document pages in a Coverbind cover, with the correct spine size, and align.

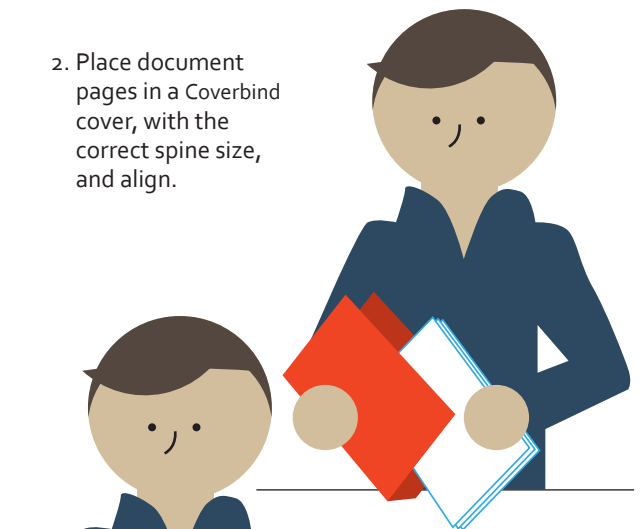

3. Bind one or several documents at a time by placing the cover — spine side down — on the heating plate.



4. Wait for the machine to signal that the thermal binding process is complete. Remove the bound document(s) from the heating plate. Allow the finished document(s) to rest — spine side down — in the cooling rack for two minutes before opening.