

Fastbind Presso Thermal Press

Instruction Manual



Provided by

MyBinding.com
When Image Matters.

Call Us at 1-800-944-4573

Declaration of Conformity

We, Maping Co, hereby declare that the following product:

Machine name: Fastbind Presso
Type: Cover finishing machine

The product fulfills the essential safety requirements for CE conformity marking according to the Low Voltage Directive 2006/95/EC and EMC Directive 2004/108/EC.

Applied standards: EN 60950 - 1:2001 (safety)
EN 61000 - 6-1:2001 (EMC immunity)
- IEC 61000-4-2 and IEC 61000-4-3
- IEC 61000-4-4 and IEC 61000-4-5
- IEC 61000-4-6

Manufacturer: Maping Co
Kuusiniemi 10, FIN-02710 Espoo FINLAND
Tel. +358 9 562 6022 Fax: +358 9 562 6215
www.fastbind.com

Warranty

Maping Co warrants this product against defects in material or workmanship as follows. For the period of twelve months from the date of purchase, repair or replace free of charge, for the original purchaser, any part or parts found by inspection to be defective by our factory authorized service outlet or by the manufacturer at Espoo, Finland. All transportation charges on parts submitted for repair or replacement under this warranty shall be paid for by the purchaser.

All service under this warranty will be furnished and performed by factory authorized service stations or by the manufacturer. Warranty service does not extend the warranty period.

This warranty is limited to the value of the product and it does not cover damage caused by:

- Transportation,
- Normal wear and tear,
- Neglected or improper maintenance,
- Misuse

The warranty will be voided if machine's type plate has been wholly or partially removed or erased. Maping Co is not responsible for any damages, including but not limited to direct, indirect or consequential damages, loss of material, profit or interruption of business. Maping Co may at any time discharge its warranty by refunding the purchase price and taking back the product.



Fastbind Presso Operating instructions

v.03 eng

Main parts

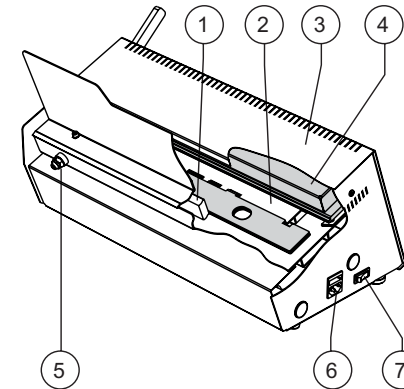

- 1 Back support
- 2 Positioning deck
- 3 Housing
- 4 Pressing tool
- 5 Adjustment screw + locking nut (back support)
- 6 AC IN
- 7 Power switch

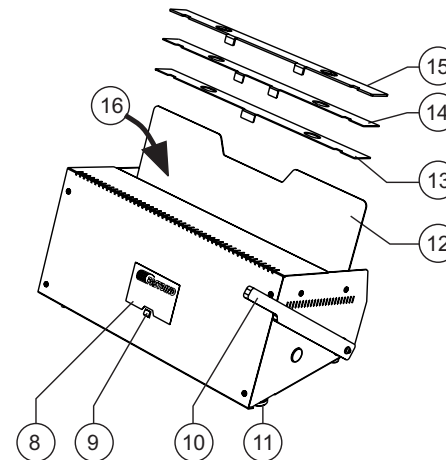

- 8 Control panel
- 9 Push button
- 10 Operating handle
- 11 Adjustable foot
- 12 Back rest
- 13, 14, 15 Spacer plates
- 16 Pressing cavity



Warning !

The surface of the press tool (5) is hot. Do not touch it. Touching it may cause burn injury. Keep hands clear from press tool when changing spacer plates (3).

Press tool (5) moves towards back support (2) when pressing from operating handle (1). Keep hands clear!

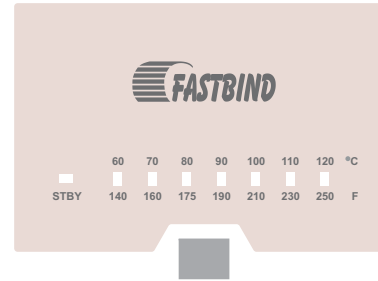
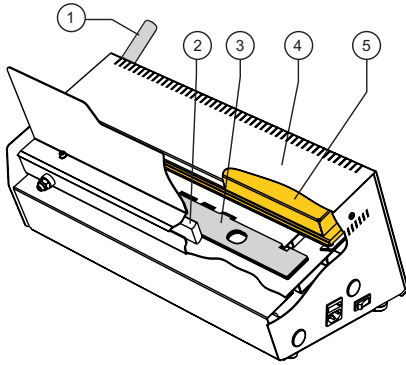

Temperature setting

After turning the power on, use the push button on the control panel to select temperature. The selected temperature LED blinks while heating up and remains lit when ready.

Using too high temperature setting may damage cover materials. To find a suitable temperature, try first a low setting. Press operating handle for five seconds and remove the book. Check if groove is properly formed and how the cover surface looks like. Increase temperature step by step as needed until a suitable setting is found for your cover material.

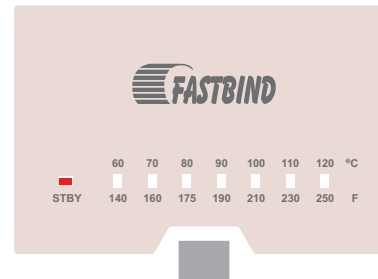

Adjusting pressing point

Books may have different spine thickness. Add or remove spacer plates to adjust pressing point (= distance A). Optimal height for the pressing point is in the center.

Adding spacer plates:
pressing point moves towards spine

Removing spacer plates:
pressing point moves away from spine

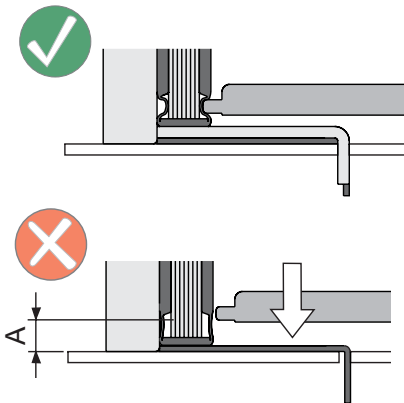

Stand by

If this equipment is not used for 60 minutes, it automatically switches off the heater and turns on the STBY LED light. Press the push button to start heating.