

Foster

On-A-Roll Lifter®

Service Guide for Power Jumbo Models

This guide provides information on some common problems that may occur and steps to resolve them.

It is the user's responsibility to exercise good judgment, common sense, safety measures and reasonable limits regarding the use of the On-A-Roll Lifter® so as not to incur risk to the user or damage to the materials being carried. In order to obtain maximum benefit from your machine, please read these instructions carefully before using the On-A-Roll Lifter®.

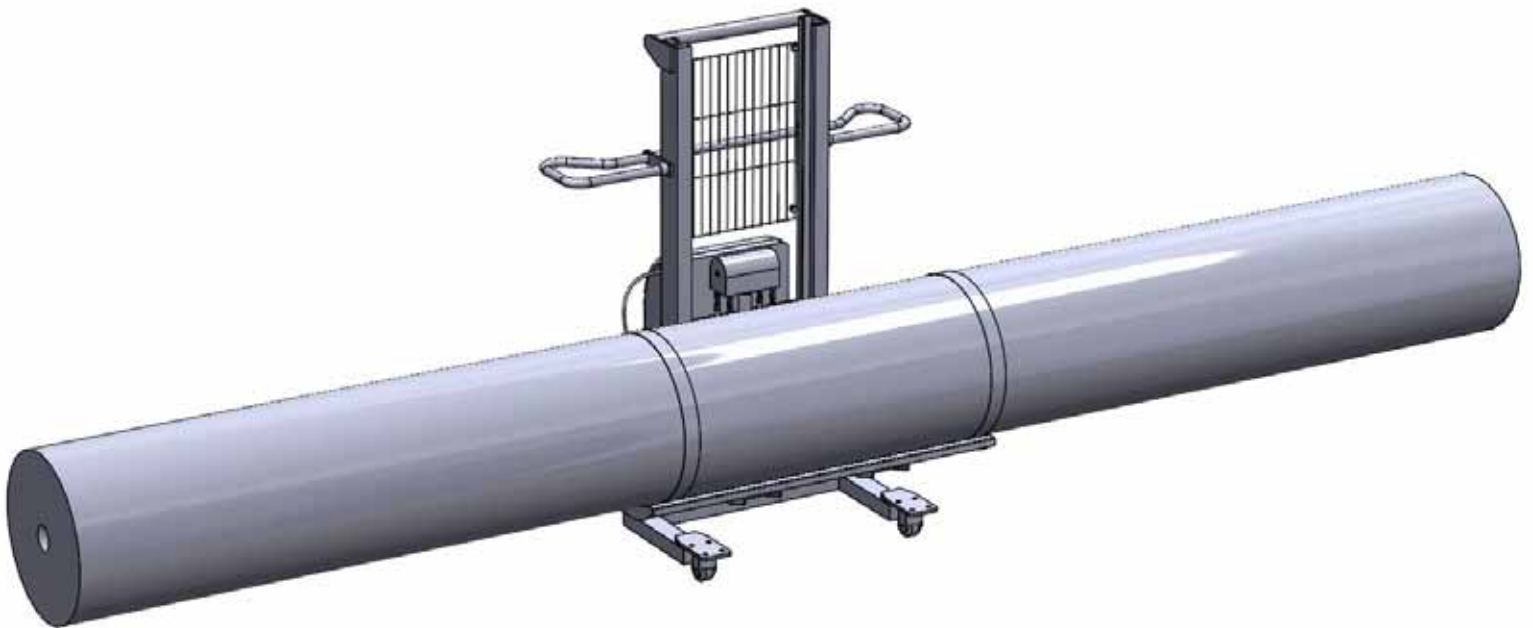

204 B Progress Drive, Montgomeryville, PA

Toll Free: 800-523-4855
information@go-foster.com

MyBinding
When Image Matters.

mybinding.com
1-800-944-4573

Contents

- 1. Parts Diagram**
 - 1.1 Complete Parts Diagram**
 - 1.2 Fork Assembly & Media Lifter Assembly**
 - 1.3 Hydraulic Pump Assembly & Push Bar Assembly**
 - 1.4 Electric Control Box Assembly**
- 2. Diagram of Hydraulic System**
- 3. Diagram of Electric System**
- 4. On-A-Roll Lifter® Wheels Not Turning Properly**
- 5. Opening & Closing the Electric Control Box**
- 6. Oil Change and Filling**
- 7. Hydraulic Pump Check**
- 8. Oil Leaking and Prevention**
- 9. Troubleshooting & Maintenance**

Parts Diagram

1 Parts diagram and list of components

- 1.1 Contact Foster before replacing any components or performing any adjustments that aren't currently mentioned in this instruction manual.

Item #	Description	Item #	Description
63006	Support/caster frame nut	63297	EU Power Cord for 220V/50HZ/1PH
63040	Hydraulic pump chain cotter pin	63298	US Power Cord for 110V/60HZ
63041	Hydraulic pump chain bolt	63299	Complete pump assembly
63050	Hydraulic pump chain guard screw	63300	Power Jumbo Chain & Fork Assembly
63087	Allen key bolt nut	63301	Chain Assembly- connected
63088	Allen key bolt washer	63302	Complete Electric Control Box
63090	Media tray strap clamp	63303	Power Jumbo Case
63091	Media tray strap bolt	63304	Battery Connector
63092	Media tray strap nut	63305	Battery Connector Nut
63093	M6 x 12mm Bolt	63306	Battery Clamper
63187	Pull Bar Long Bolts M6 x 45mm	63307	Electric Box Cover
63205	Front Caster Wheel Assembly	63308	Electric Pump
63207	Wire Shield Protector	63309	Oil Pipe Adapter
63208	Chain wheel cover	63310	O Ring for Electric Pump
63209	5cm wide Strap Pin	63311	Plug for Electric Pump
63210	8cm wide strap clamp	63312	Key Switch for Electric Box
63211	Support Strap with buckle	63313	Coulometer
63212	Jumbo Media Tray	63314	Charging Status Indicator
63213	Jumbo Media Tray Assembly	63315	Control Faceplate
63214	Jumbo Push Bar Assembly	63316	Lower Operating Button
63216	Hydraulic Pump Double Chain Wheel	63317	Raise Operating Button
63217	Hydraulic pump chain guard washer	63318	Faceplate Screw
63219	Jumbo Fork Frame	63319	Electric Box Cover Screw
63220	Roller Bearing Thread Screw for Jumbo	63320	Electric Box Cover Washer
63221	Roller Bearing for Jumbo	63321	Battery Clamper Lower Bolt
63222	Snap Ring	63322	Battery Clamper Lower Washer
63223	Nylon Cap	63323	Battery Clamper Lower Nut
63225	Rear Caster Wheel Assembly	63324	Mounting Bracket for Electric Box
63226	Thread Screw for Rear Caster Wheel	63325	Power Jumbo Frame
63228	Front Caster Wheel Mounting Bolt	63326	Pump Rest Block
63229	Front Caster Wheel Mounting Washer	63327	"U" Bolt for Power Jumbo
63230	Front Caster Wheel Mounting Nut	63328	"U" bolt nut
63248	Wire Shield Protector Bolt	63329	"U" bolt washer
63249	Wire Shield Protector Washer	63330	Bolt for Mounting Bracket
63250	Wire Shield Protector Bracket	63331	Washer for Mounting Bracket
63293	Charger- 110V/60HZ, US Plug	63332	Large Washer for Mounting Bracket
63294	Fuse for Power Unit- All Lifters	63333	Nut for Mounting Bracket
63295	Battery for Power Unit- All Lifters	63334	Oil tube & Union for Hydraulic Pump
63296	Charger- 220V/50HZ/1PH, Euro plug		

Parts Diagram

1 Parts diagram and list of components

- 1.1 Contact Foster before replacing any components or performing any adjustments that aren't currently mentioned in this instruction manual.

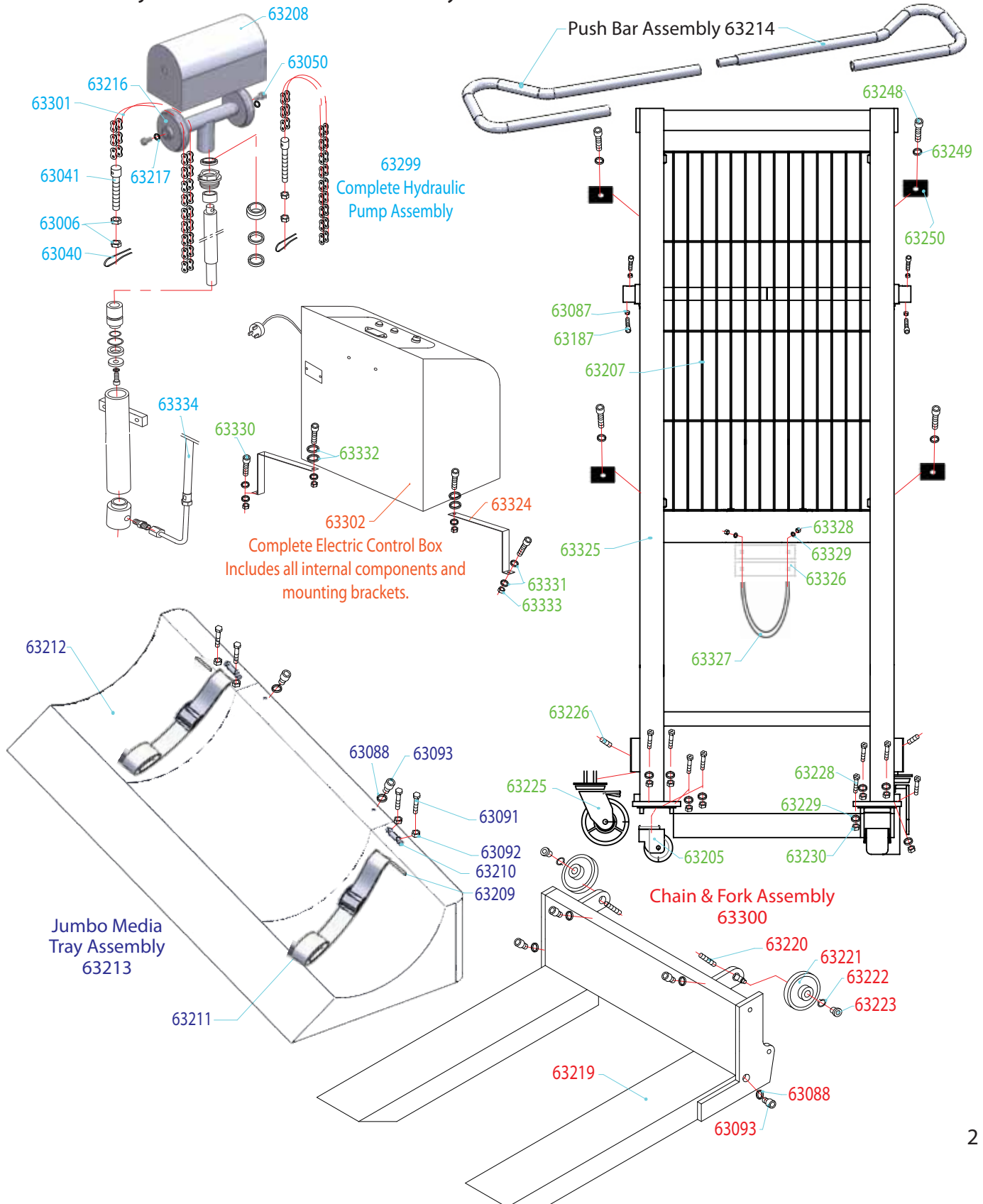

Parts Diagram

1.2 Parts diagram: Chain & Media Tray Assembly

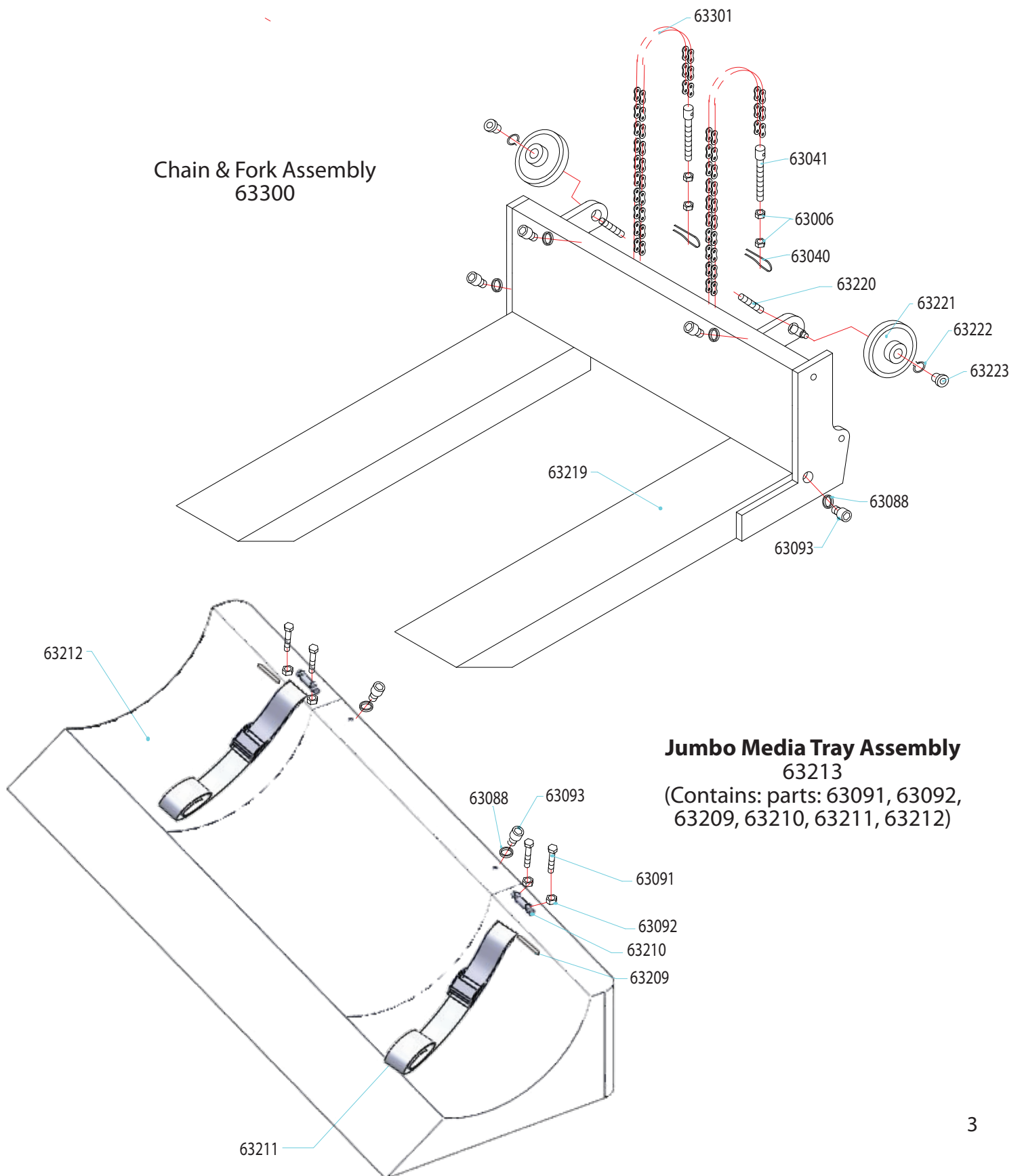

Parts Diagram

1.3 Parts diagram: Hydraulic & Handle Bar Assembly

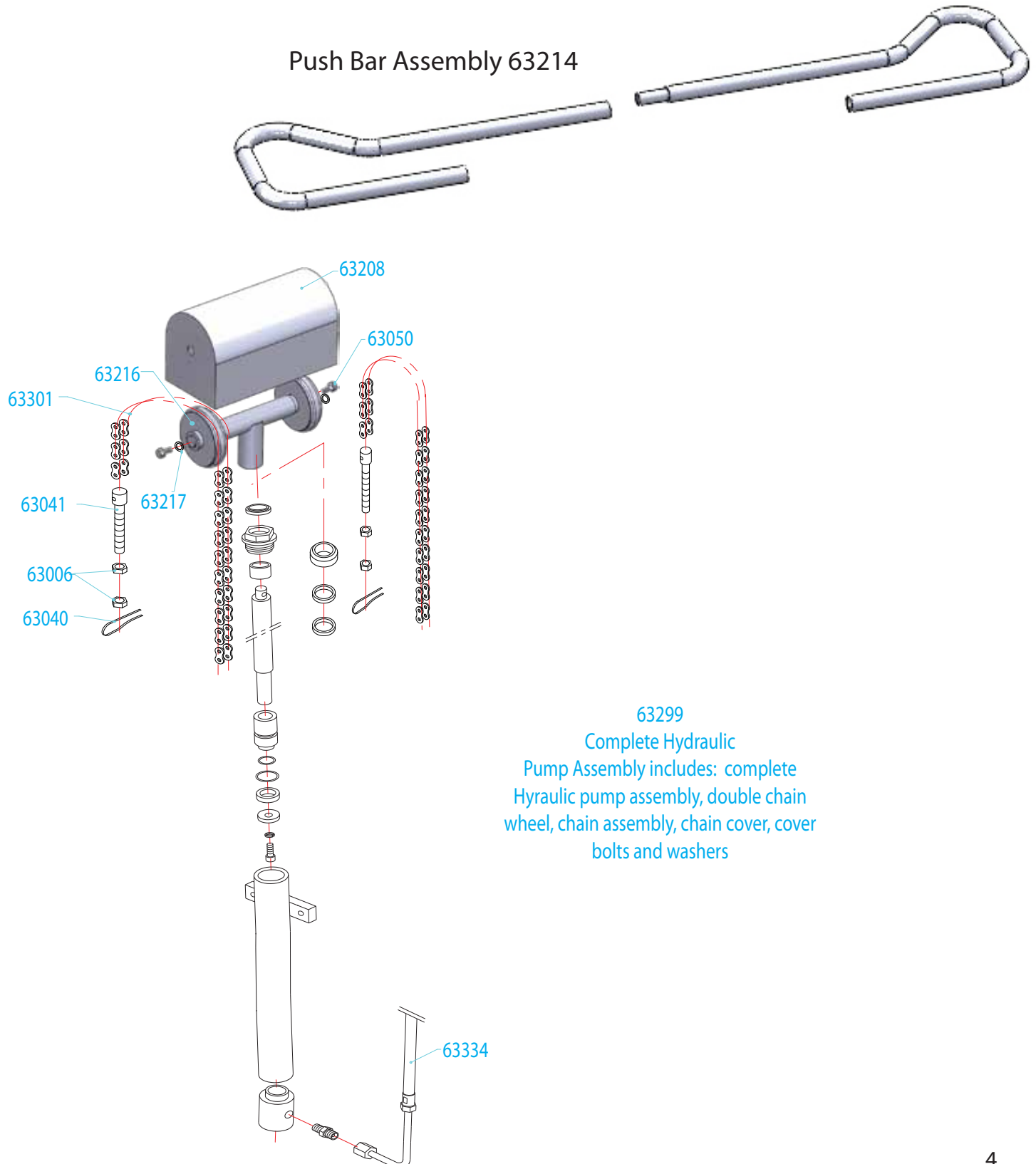

Parts Diagram

1.4 Parts diagram: Electric Control Box Assembly

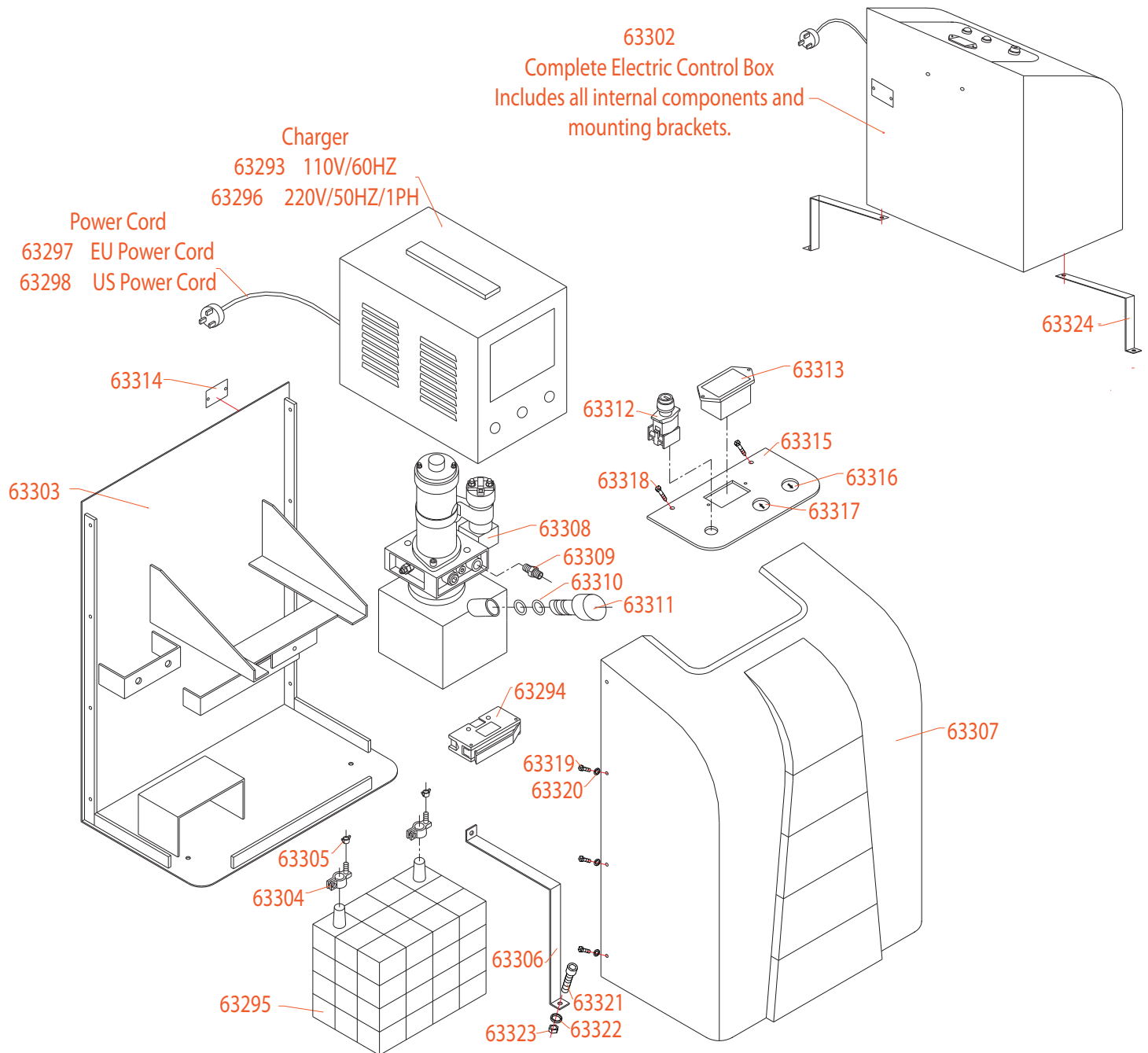

2. Diagram of Hydraulic System

YG	Hydraulic Cylinder
DF	Magnet Valve
TF	Speed Control Valve
YF	Discharge Valve
M	Electric Pump

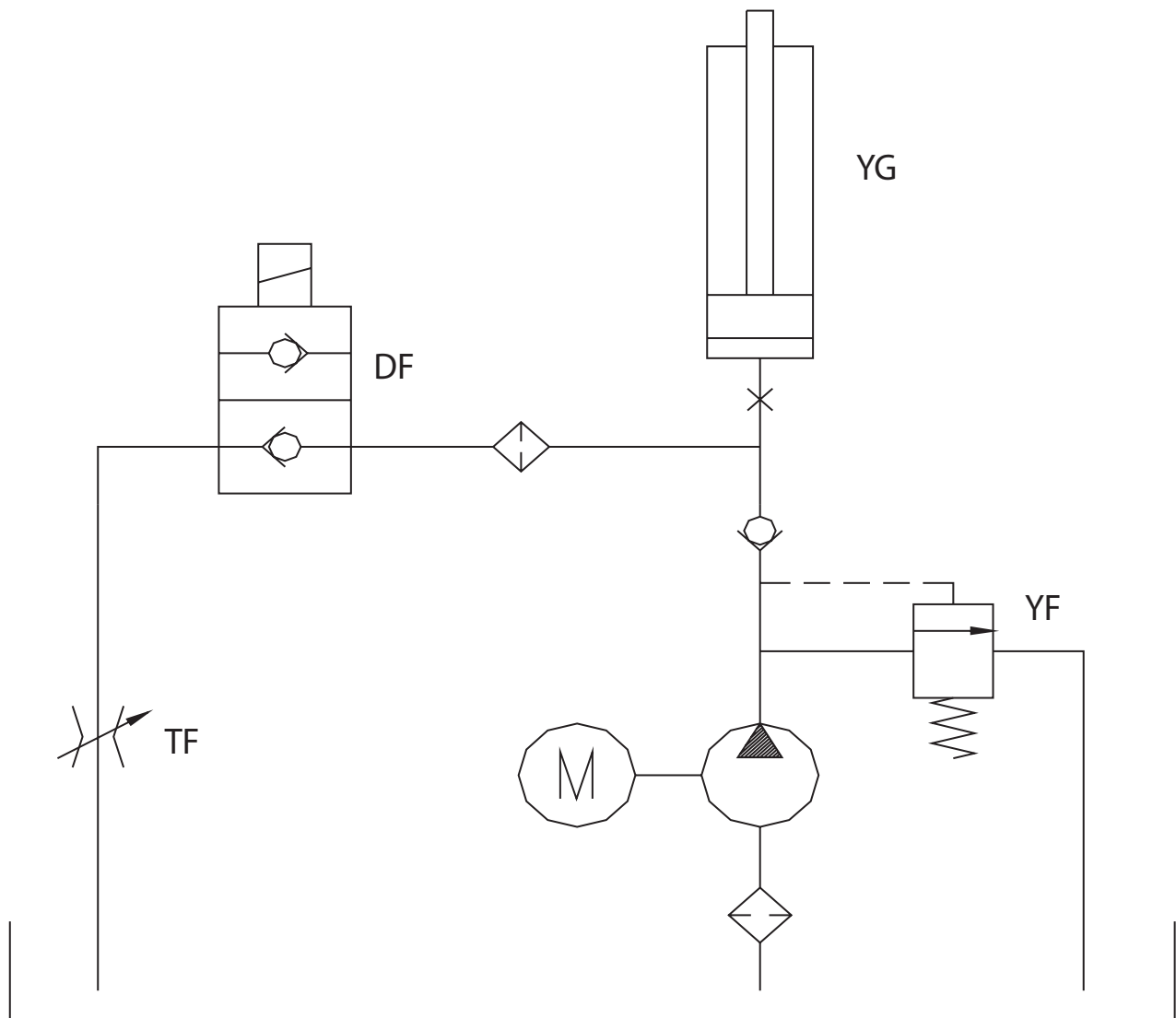

3. Diagram of Electric System

If unfamiliar with electric, have a trained Electrician service this unit.

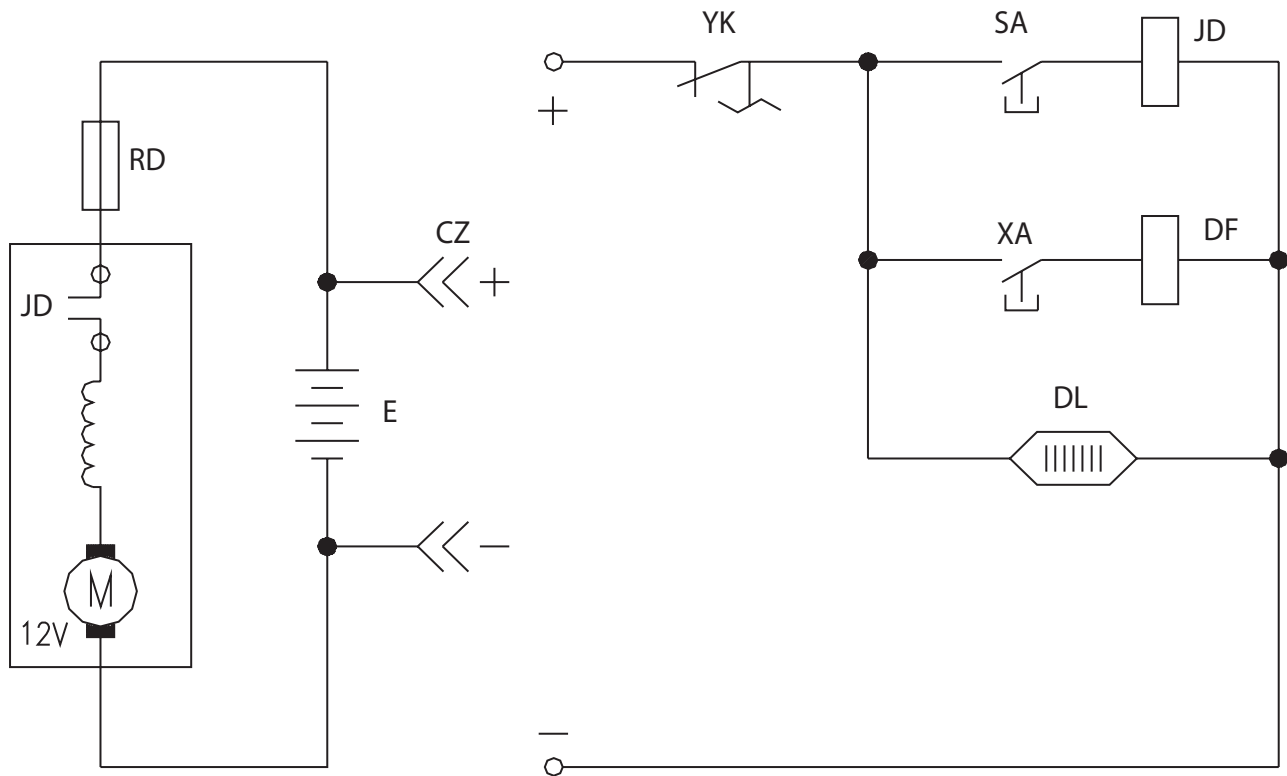

JD	Relay
RD	Fuse
M	DC Motor
E	Battery
CZ	Charger Socket
YK	Switch
SA	LIFT- Button
XA	LOWER- Button
DF	Magnet Valve
DL	Coulometer

4. On-A-Roll Lifter® Wheels Not Turning Properly

1. Lift the front side to ensure the front wheels are intact and turning. Replace if damaged.
2. Lift the back side to ensure the steering wheels are intact and turning. Replace if damaged.
3. Ensure the bottom cross bar on the frame is straight and not bowed. If the cross bar is bowed, the likely cause is that the user has dropped the roll media onto the tray or the roll weight is in excess of the recommended weight. Replace if damaged.

5. Opening & Closing the Electric Control Box

1. Using a Phillips Head Screwdriver, remove the 6 screws on the side of the Electric Control Box Cover. There will be 3 on each side.
2. Using a Phillips Head Screwdriver, remove the 2 screws located on the Electric Control Box Faceplate on top.
3. Gently remove the Cover and Faceplate being mindful of the electrical connections to leave intact.

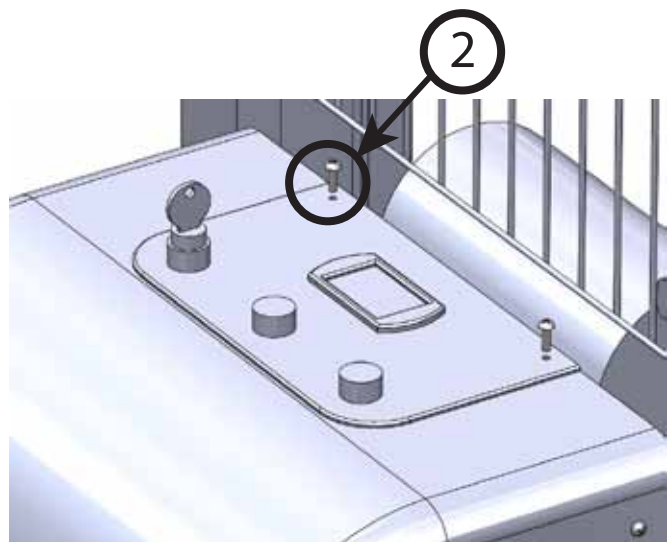
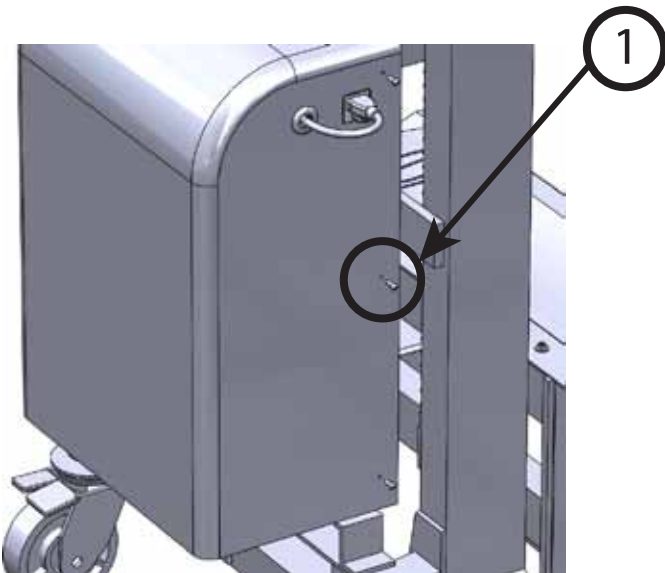

To install the cover, line up the cover and faceplate back in position. The screw holes should match the holes on the unit. Using a Phillips Head Screwdriver insert the top 2 faceplate screws followed by the 6 side screws until the cover is securely in place.

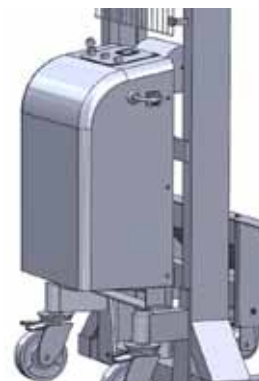

6. Oil Change and Filling

1. Lower the lifter tray to the lowest position.
2. Remove the Electric Control Box cover as instructed in the previous step 5.
3. Using a flathead screwdriver or 8mm socket wrench, loosen the clamp ring that secures the oil tank to the pump. Remove the tank. ***
4. Drain the old oil, clean the valve plate and the oil tank.
5. Fill the pump unit 80% of the tank with type L-HM46 Hydraulic oil (equivalent to ISO VG46).
6. Inspect the connections to avoid oil leaks.
7. Reassemble the pump section and ensure all parts are securely tight and in place.

*** If not able to remove the tank easily with loosening the clamp ring:

- A. Using a 17mm wrench remove the Union from the Oil Tube. Note that if oil is in the line it will start to leak out on removal and you will need to have something to collect the oil while removing the Union and Oil Tube connection.
- B. Draining the Oil Tank from the drain screw. Place an oil pan to collect the oil. Using an 8mm Allen Key, remove the drain screw and allow the oil to drain into the pan.
- C. Oil can be checked and refilled from the Oil Cap on the top of the tank.

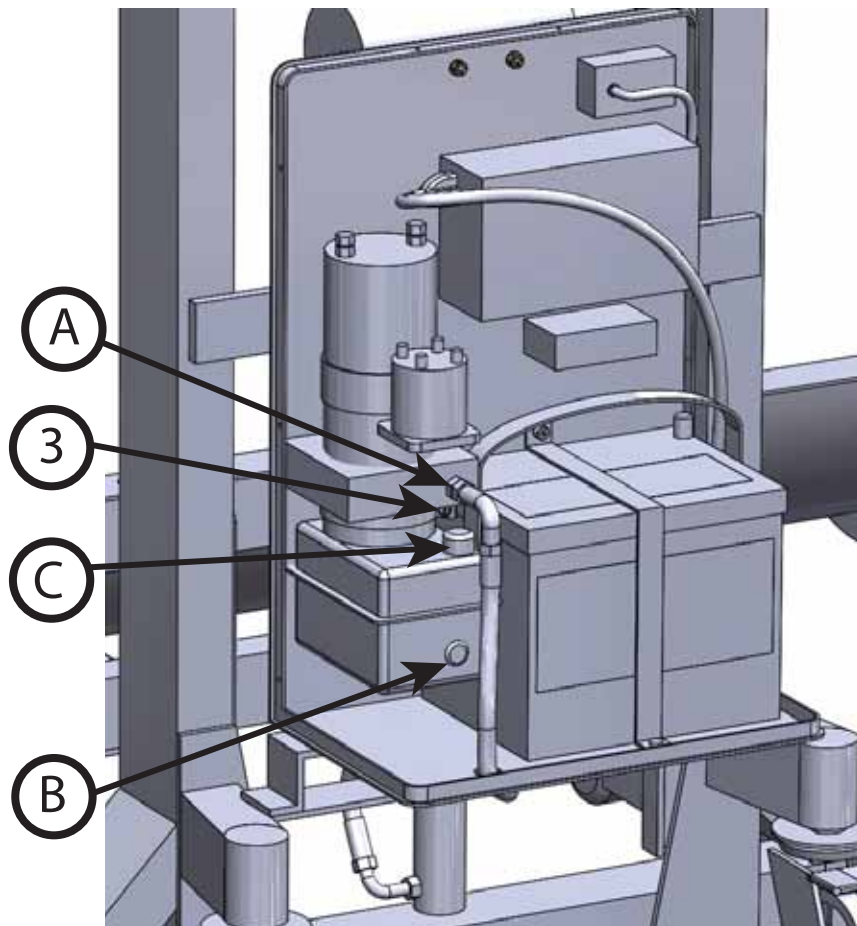

7. Hydraulic Pump Check

Regularly changing your hydraulic fluid is the best way to prevent hydraulic pump leaks. If a leak has occurred, check all connections to the hydraulic pump to make sure everything is properly tightened.

1. Check Piston Valve.
2. Check both union connections on the Oil Tube.
3. Check top connection where Double Chain Roller attaches to Hydraulic Pump.

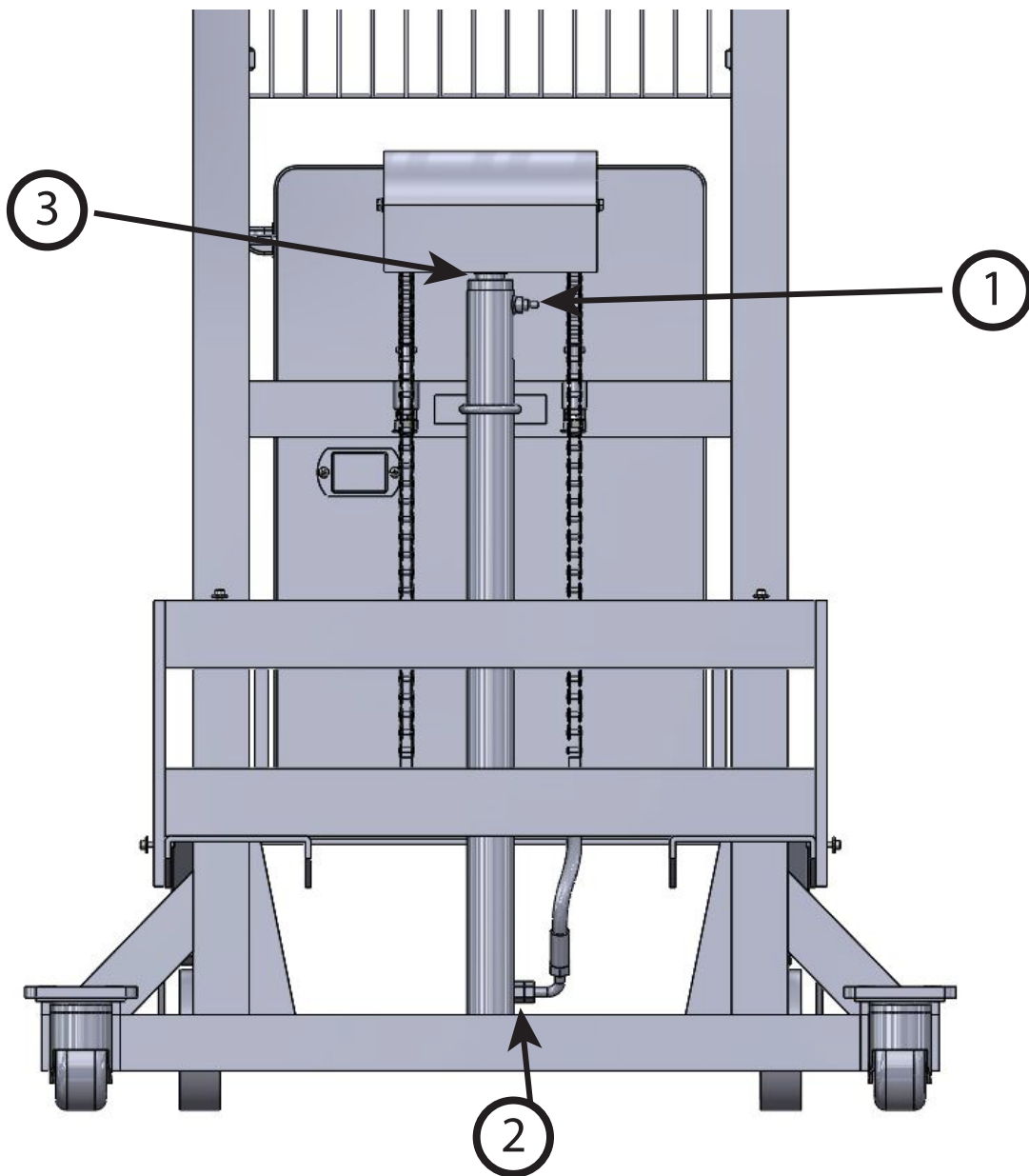

8. Oil Leaking and Prevention

If any of the connection points are loose in Step 7, tighten them to prevent leaking. If any connection point is damaged, those parts will need to be replaced. If all 3 connections appear fine then the Hydraulic Pump will need to be replaced.

Hydraulic Pump Replacement

1. Remove the nuts and cotter pins from both chains attaching to the top section of the chain assembly.

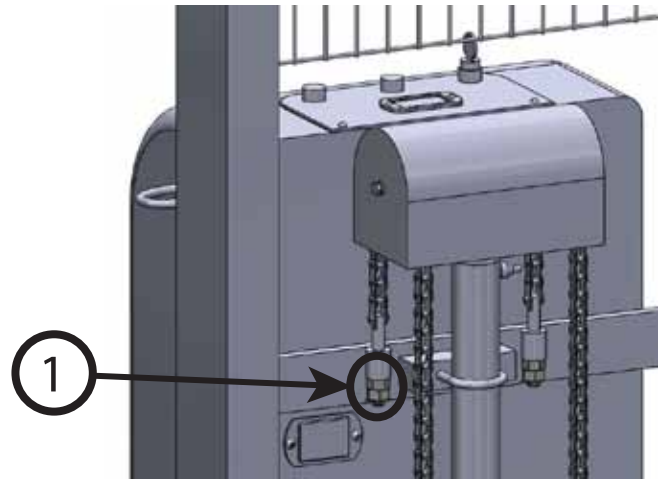

2. Remove 2 washers and nuts from the U bolt.

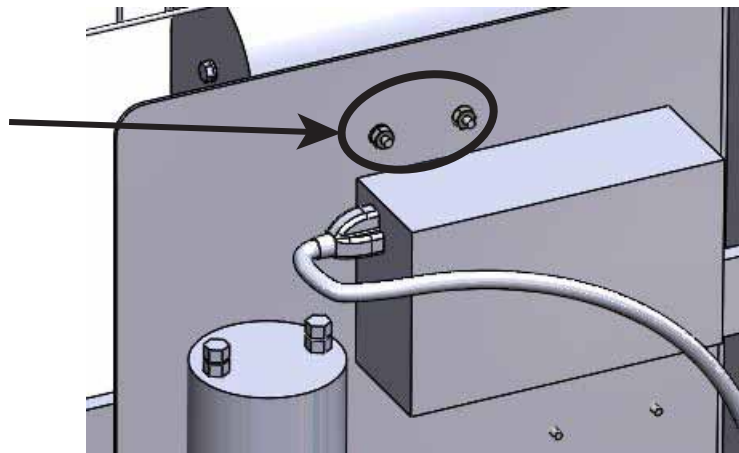

3. Lift the hydraulic pump.
4. Pack it properly into thick packaging material to avoid the oil spilling.
5. Replace with new hydraulic pump.
6. Tighten 2 washer and nuts from the U bolt.
7. Reattach the nuts and cotter pins to each chain.

9. Troubleshooting & Maintenance

No.	Problem / Description	Cause / Reason	Solution
1	Coulometer doesn't indicate when key switch is ON.	1. Terminals and inserts are loose. 2. Switch is out of order.	1. Check terminals and all connections to ensure nothing is loose or damaged. 2. Check and change the switch or damaged wires.
2	Roll tray does not lift up when pushing the LIFT button.	1. Terminals and inserts are loose. 2. Oil is low on Hydraulic Pump. 3. Fuse is broken. 4. Lift Button is broken.	1. Check terminals and all connections to ensure nothing is loose or damaged. 2. Fill oil to proper level. 3. Replace Fuse. 4. Check and replace lift button.
3	Lifting speed is too slow when pushing LIFT button.	1. Battery does not have enough power. 2. Relief valve is not in proper position. 3. Roll weight exceeds lifting capability.	1. Recharge the battery. 2. Adjust the relief valve. 3. Check roll weight to ensure it is 990lbs (450kg) or less.
4	Roll tray can't lift to the top.	1. Oil is low on Hydraulic Pump. 2. Other object blocking.	1. Fill oil to proper level. 2. Remove object that is blocking the lifter from raising.
5	Electric pump does not work.	1. Battery does not have enough power. 2. Terminals and connector are loose. 3. Electric pump is broken.	1. Recharge the battery. 2. Check terminals and connector. 3. Check and replace.
6	Roll tray does not lower when pushing LOWER button.	1. Fuse is broken. 2. Lower button is broken. 3. Magnet contactor is broken. 4. Other object blocking.	1. Check and replace Fuse. 2. Check and replace button. 3. Check and replace magnet. 4. Remove object that is blocking the lifter from lowering.
7	Coulmeter shows nothing, red light is flashing or the battery doesn't have enough power.	1. Terminals and inserts are loose. 2. Hasn't been charged long enough. 3. Local electric doesn't match the charger. 4. Battery is worn out.	1. Check terminals and all connections to ensure nothing is loose or damaged. 2. Charge the unit longer. 3. Connect charger to match electric requirements. Or have a certified electrician correct the outlet. 4. Check and replace the battery.
8	Hydraulic system has oil leaks.	1. Oil seals are broken or loose.	1. Replace oil seals or tighten those that are loose.
9	After recharge, Coulometer shows low electricity and lifting speed is slow.	1. Battery hasn't been charged long enough. 2. Battery is worn out. 3. Charger is warn out.	1. Recharge the battery. 2. Check and replace the battery. 3. Check and replace the charger.

9. Troubleshooting & Maintenance

Specifications	Battery Charger & Hydraulic Oil
Electric	12V/60AH DC Motor
Battery	Maintenance free lead acid battery 10" L x 6.7" W x 8" H (255 x 170 x 205mm)
Battery Charger	Built-in 110V AC charger
Hydraulic Oil	L-HM46 Hydraulic oil (equivalent to ISO VG46)

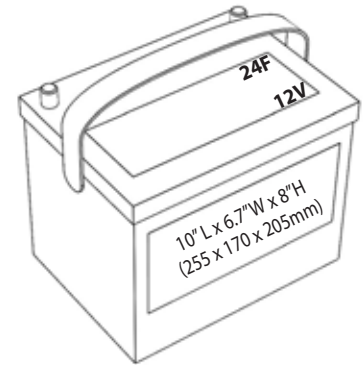

Replacing the Battery.

1. Using a 5mm Allen Key and a 10mm Wrench, remove both the top and bottom bolts and nuts from the battery clamber.
2. Disconnect the old battery.
3. Install the new 12V maintenance free lead acid battery.
4. Reconnect the battery and clamber.

Replacing the Fuse.

1. On the fuse box, open the door to get access to the fuse.
2. Slide the fuse out of its holder.
3. Insert new fuse and line up both ends on the connectors.
4. Close the fuse box.

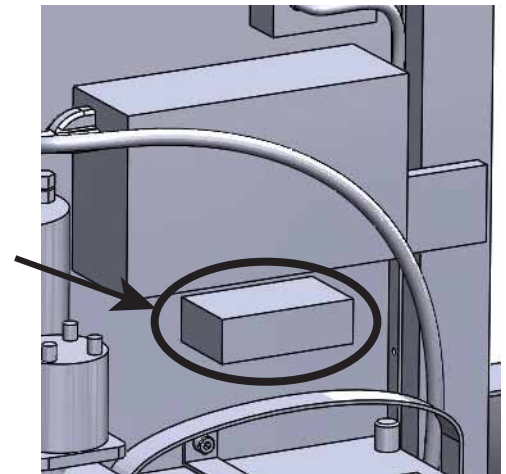

Replacing the Key Switch, LIFT, or LOWER buttons.

If unfamiliar with electric, have a trained Electrician service this unit.

1. Use a screwdriver to remove the 2 screws holding the button in place.
2. Disconnect the wires keeping them separated from each other.
3. Install the new button and reconnect the wires.

