

SealerSales W-3501

***14" I-Bar Sealer w/ Film Roller
and Round Wire***

Instruction Manual



Provided by

MyBinding.com
When Image Matters.

Call Us at 1-800-944-4573

TROUBLESHOOTING

MALFUNCTIONS	REASONS	SUGGESTIONS
No sealing Power lamp is off	Disconnected plug Power cord is broken Transformer is broken	Check or change the plug Replace or repair the cord Replace the transformer
No sealing Power lamp is on Sealing lamp is on	Heater (heating element) is broken Spring hook our mounting spring is loose or in poor contact Terminals of the heating element are in poor contact	Replace the heater Clean or tighten spring hook connection Clean the terminals and adjust if needed
No sealing Power lamp is on Sealing lamp is off	Microswitch is activated Defective microswitch	Adjust the microswitch lever Adjust the microswitch position Replace the microswitch
Teflon cloth burn	Timer malfunction Prolonged heating time	Replace timer or relay Decrease the timer setting
Heating wire breaks	Worn Teflon adhesive	Replace the Teflon adhesive
Seal is wrinkled	Heating timer is set too high Cooling time is not enough	Lower the timer setting Continue pressing the upper lever for 1-2 seconds after the light goes off
Imperfect seal	Worn Teflon cloth Worn silicone rubber	Replace Teflon cloth Replace silicone rubber
Broken seal	Prolonged sealing time	Decrease timer setting
Non-full-weld seal	Sealing time is too short	Increase sealing time
Seal sticking	Dirty Teflon cloth Dirty sealing bar	Clean the Teflon cover Clean the silicone rubber sealing bar

I-BAR SEALER

for shrink wrapping

OPERATING INSTRUCTIONS

MODELS

W-350I, W-500I, W-650I, W-750I, W-900I

W-350IC, W-500IC, W-650IC,

W-750IC, W-900IC

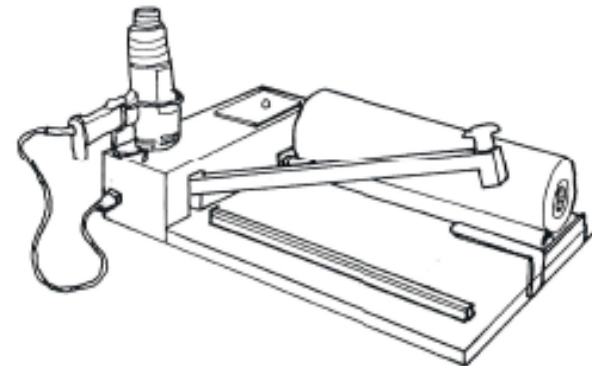

BASIC PARTS LIST

For parts ordering and more detailed part information, please refer to parts diagram at the end of the manual.

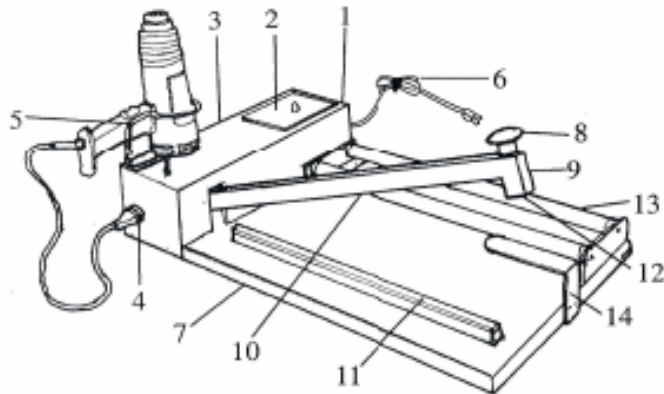

#	Part	#	Part
1	Control Box Cover	8	Handle Knob
2	Timer Set	9	Upper Sealing Arm
3	Transformer	10	Heating Element
4	Socket for Heat Gun	11	Silicone Rubber
5	Heat Gun Holder	12	Spring Hook Set
6	Power Cord	13	Roller
7	Metal Base	14	Film Separator

CONNECTION DIAGRAM

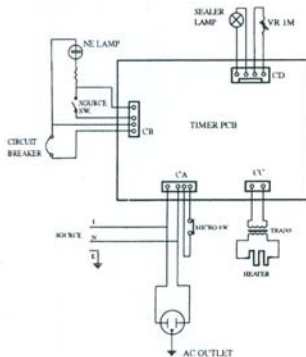

REPLACEMENT KIT INSTRUCTIONS

INSTALLING NEW PARTS (ELEMENT/TEFLON)

- **Note:** A good rule of thumb is to replace the Teflon adhesive each time you change your element.
- Install a new Teflon adhesive on the seal arm, making sure that it extends past the red fiber plate on the metal seal arm.
- Place a new heating element over the Teflon adhesive. Fix the rear end of the heating element by attaching the screw through the eyelet. Tighten the screw.
- Attach the heating element, spring and plastic washer to the terminal hook in the front by the handle knob.
- Squeeze the spring and insert the terminal hook to its original position at the sealer's arm.
- Place another piece of Teflon adhesive over the heating element.

CHANGING THE BLADE ON CUTTER BRACKET

- **Note:** Use extreme caution when changing blade.
- Slide the cutter bracket to the notched slot in the groove of the sealer's arm and pull upward to remove the entire cutting bracket (w/ old blade attached).
- Using a screwdriver, loosen screw which holds the blade plate. Slide blade out with caution.
- Put a new blade and then the blade plate. Be sure the blade plate latch is in the second predrilled hole from the tip of the cutting blade.
- Make sure that both the blade and the blade plate are in position under the grooves of the cutting bracket.
- Place the complete cutting bracket into the groove on the sealer's arm by placing the bracket through the notched slot first. The blade side should face towards the element side of the sealer.

REPLACEMENT KIT INSTRUCTIONS

****Always unplug the unit from the power source before making any repairs.**

REMOVING THE USED PARTS (ELEMENT/TEFLON)

- There are two Teflon adhesives (one is under and one is above the heating element.)
- Peel off the Teflon adhesive strip that covers the heating element.
- Loosen the screw that holds the heating element. *A hole is provided for easy access on the base (platform) of the sealer to reach the rear element screw.* Simply tilt the unit to loosen the screw.
- Squeeze the spring on the heating element hook at the sealer's arm and release the heating element. Keep the spring hook and plastic washer.
- Peel off the Teflon adhesive under the heating element.

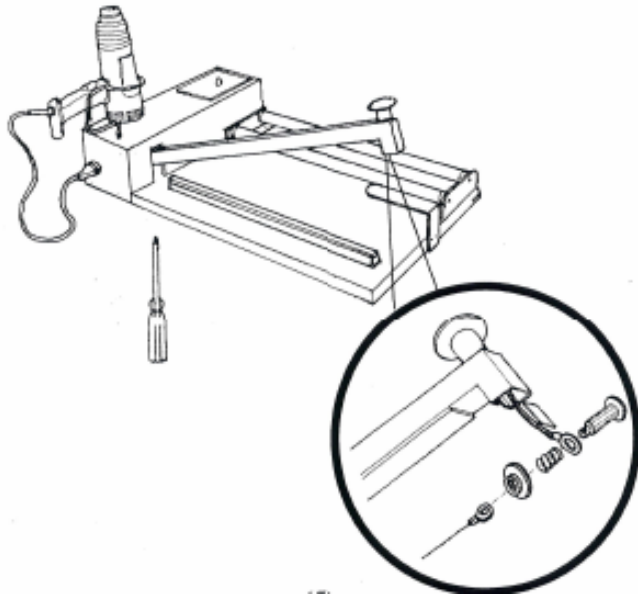

IMPORTANT POINTS TO REMEMBER

- **Read** all instructions before use. Save these instructions for later use.
- **Follow** all warnings and instructions marked on the product.
- **Unplug** this product from the power source before cleaning and/or changing any parts
- Do not rest anything on the power cord. Do not place the machine where the power cord may be stepped on or pulled.
- Always **keep out** of reach of **children** and pets.
- This sealer should only be in use with an **operator** in attendance.
- **Never insert** clothing, hands, fingers between the sealing jaws of sealers.
- **Never touch** the heating elements with bare hands while the sealer is plugged into a power source, or in operation, or just finished operation. It will be **HOT**.
- Be sure to **check** for **worn parts** before starting operation.
- Do not operate with a **damaged power cord** or plug.
- Always keep the unit **clean**. Do not use water. Silicone spray may be used to clean the unit. Be sure the unit is unplugged from the power source before cleaning.
- When changing **blade** (for sealers with cutters), be **careful** of the sharp edge.
- When changing the teflon adhesive, be sure the entire surface under the **heating element** is covered with a teflon adhesive. Bend down the excess teflon adhesive on both ends. This prevents the heating element from breaking and the machine from **grounding**.
- When replacing the **fuse**, be sure the exact voltage and ampere is used.
- Be sure to keep a record of your model number. Specify this number when ordering parts.
- When replacing any parts, be sure to **mark down** the exact locations of the connections.

SPECIFICATIONS

Model	W-350I/W-350IC	W-500I/W-500IC	W-650I/W-650IC	W-750I/W-750IC	W-900I/W-900IC
Power	110V/450W	110V/600W	110V/800W	110V/1000W	110V/1200W
Weight (lbs)	38	44	50	51	65
Sealing Length	14"	20"	26"	30"	36"
Cutting Length	13"	19"	24 1/2"	28 3/4"	34 1/2"
Dimensions	23.5" x 16" x 5.5"	29.5" x 16" x 5.5"	35" x 16" x 5.5"	37.5" x 16" x 5.5"	45" x 16" x 5.5"

OPERATING INSTRUCTIONS

Step 1. Set the power switch to ON position.

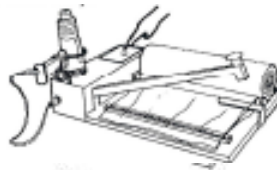

Step 2. Set the Sealing Timer according to film thickness. **Always start with a low setting and increase gradually to the right setting.

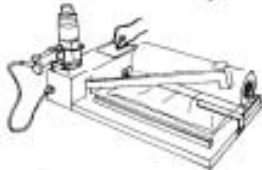

Step 3. Place the object to be sealed between your film.



Step 4. Press the Seal Bar down and seal.

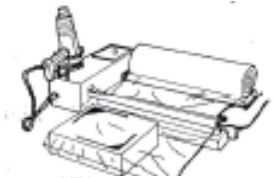

Step 5. Tear the resulting bag from the rest of the film. Place the open side between the seal bars and seal the opening.

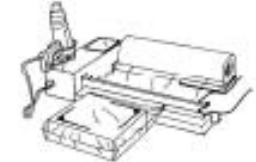

Step 6. Use the heat gun to shrink the film evenly.

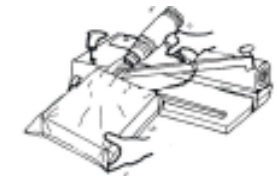

IMPORTANT POINTS TO REMEMBER

- Always unplug unit from power source before attempting any maintenance.
- Always keep the sealing platform clean and remove any residue found on the platform and Teflon tape. Silicone spray may be used for this purpose.
- When replacing the heating element, always change the bottom Teflon adhesive. The Teflon serves as a barrier between the metal seal arm and the heating element. Never allow the element to come in contact with the sealer arm as this will damage the timer.
- Occasionally check the condition of the silicone rubber which will affect the quality of the seal if damaged or worn.

WH I-Bar Sealers

W-350I, W-500I, W-650I, W-750I, W-900I

W-350IC, W-500IC, W-650IC, W-750IC, W-900IC

Spare Parts **DIAGRAM**

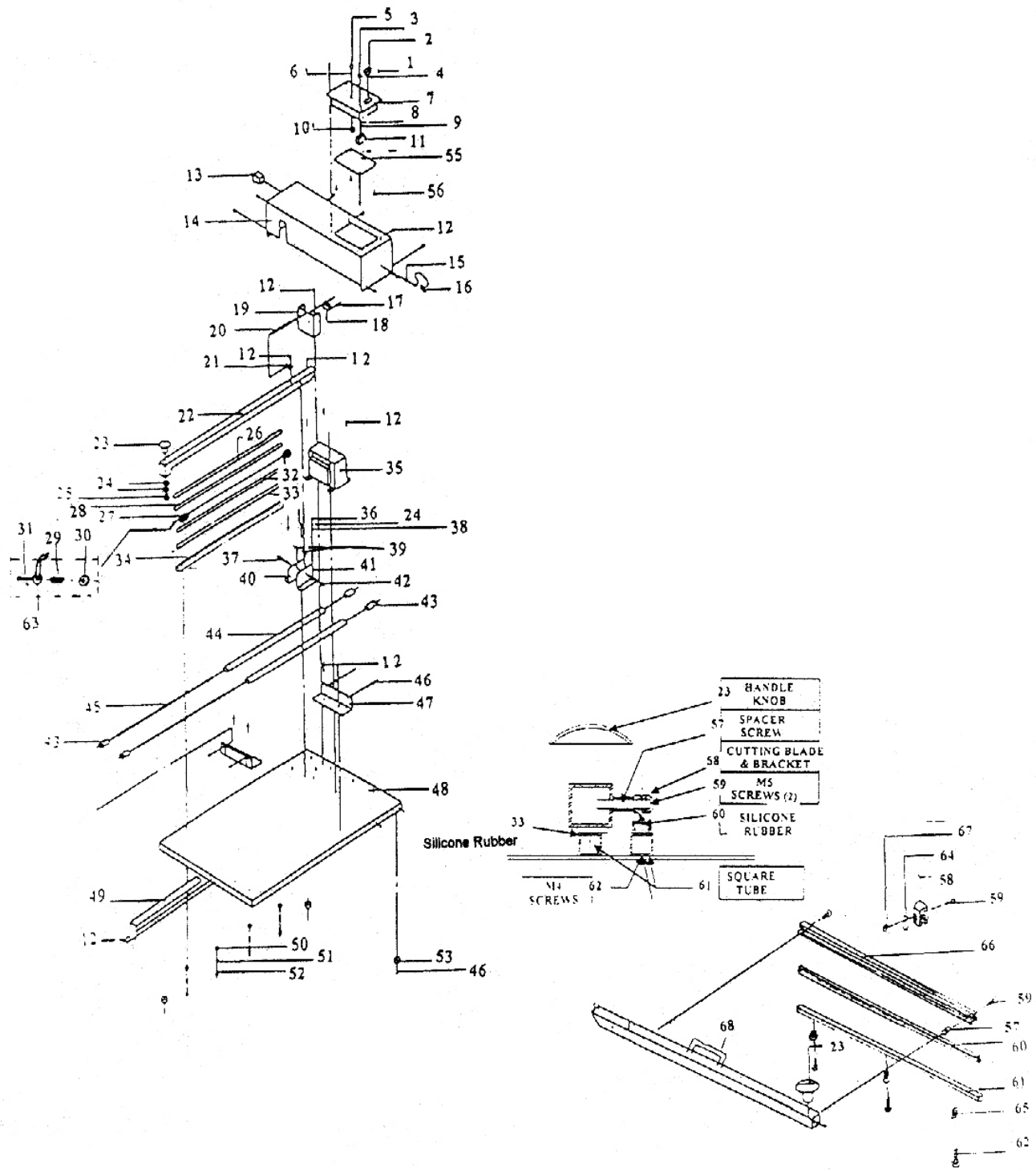

■ WH I-Bar Sealers

W-350I, W-500I, W-650I, W-750I, W-900I

W-350IC, W-500IC, W-650IC, W-750IC, W-900IC

Spare Parts **D I A G R A M**

WH I BAR SEALERS			
No.	Description	No.	Description
1	Screw 4*8 / Control Panel	36	Screw M6*16
2	Power Switch	37	Screw 3/8* 1 1/2
3	Pilot Lamp / LED	38	Washer M6*16
4	Nut for Circuit Breaker	39	Bushing
5	Knob for (Variable Resistor)	40	Upper Lever Bracket (Left)
6	Nut for (Variable Resistor)	41	Upper lever Bracket (Right)
7	Control Panel	42	Screw 3/8
8	Spring Washer	43	Bearing
9	Nut	44	Film Roller/each
10	Variable Resistor 1M	45	Shaft
11	Circuit Breaker, 7A/10A/15A	46	Screw M5*8
12	Screw 4*8	47	Roller Fixed Plate
13	Power Receptacle 3P	48	Based Plate
14	Control Box	49	Bags Support/Film Separator
15	Grommet	50	Washer 5/16*23
16	Power Cord	51	Screw 5/16
17	Screw 3* 15 for #18	52	Screw 5/16* 5/8
18	Limit Switch / Microwitch	53	Rubber Foot
19	Limit Switch Holder	54	Adhesive Teflon Tape 19mm
20	Spring Arm, same as W-Long Hand	56	PC Support
21	Spring Holder, L-Bracket	63	Terminator 2-6R
22	Upper Lever Arm	68	Center Handle Grip/Optional
23	Lever Knob (same as W-long Hand)	69	Inside Box
24	Spring Washer M6 for# 23	69a	Outer Box
25	Screw M6*20 for #23	57	Spacer
26	Fiber Plate, yellow 3/8" wide	58	Cutting Blade Bracket
27	Heating Wire 0.8mm, 2.7mm	58a	Cutting Blade Braket with Blade
28	Insulated Plate, 3/4" TA, 6mil	59	Screw M3 *M12
29	Spring, for Hook Assembly	60	Silicon Rubber Cutter
30	Plastic Washer for Hook Assembly	61	Square Tube
31	Spring Hook, for Hook Assembly	62	Screw M4*M25
31a	Spring Hook Assembly SHA-WHI includes (29-31)	64	Blade
32	Insulated Tape, 1/2" TA, 3 mil	65	Spring
33	Silicone Rubber	66	Silicone Bracket
34	Silicone Bracket	67	Screw M3*M3
35	Transformer	68	Complete Cutter Unit (same as W-Long Hand)