

# ***Akiles Crimp@Coil Heavy Duty Automatic Coil Crimper***

Instruction Manual



Provided by  
**MyBinding.com**  
*When Image Matters.*

Call Us at 1-800-944-4573

## INTRODUCTION

CONGRATULATIONS ON THE PURCHASE OF YOUR NEW Crimp @ Coil. A PROFESSIONAL AND EFFICIENT COIL BINDING MACHINE. YOUR Crimp @ Coil WAS CAREFULLY DESIGNED WITH A FULL RANGE OF FUNCTIONS AND USING PREMIUM QUALITY COMPONENTS TO GUARANTEE AN EFFORTLESS AND PROFESSIONAL BIND, AS WELL AS MANY YEARS OF TROUBLE-FREE SERVICE.

## IMPORTANT

WE RECOMMEND THAT YOU TAKE A FEW MINUTES TO FAMILIARIZE YOURSELF WITH THE FUNCTIONS OF YOUR NEW Crimp @ Coil. YOU WILL FIND THAT WITH JUST A LITTLE PRACTICE, ANYONE CAN ACHIEVE PROFESSIONAL RESULTS.

## FEATURES

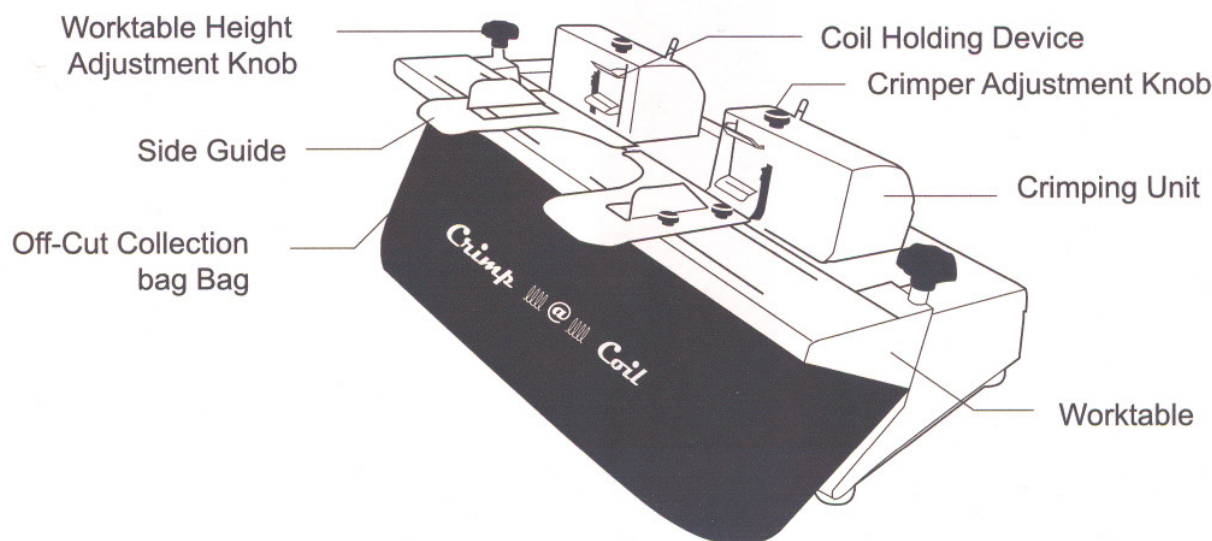

## ASSEMBLY

1. Place your new Crimp @ Coil on top of a sturdy working table. [See Picture 1](#)
2. Turn on switch and press foot pedal to test the crimper unit. [See Picture 2](#)

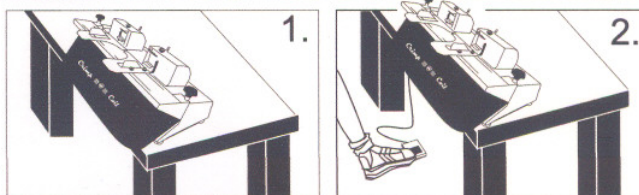

## SAFETY INSTRUCTIONS

1. Keep fingers, hair, jewelry, necktie and any loose clothing or objects away from the electric crimpers, as they may be accidentally crimped by the electric crimpers.
2. Do not allow children to operate the machine. The Crimp @ Coil is not a toy.
3. Always turn switch-off and place foot pedal out of reach when machine is not in use.
4. To reduce the risk of electric shock, never operate the Crimp @ Coil near water.
5. Do not use the Crimp @ Coil if power cord is damage .
6. Do not allow the electric cord to be in contact with hot surfaces.
7. In case of malfunction, return the unit to you distributor for service. This equipment does not contain any part that can be serviced by the consumer or operator.





## Crimping Unit

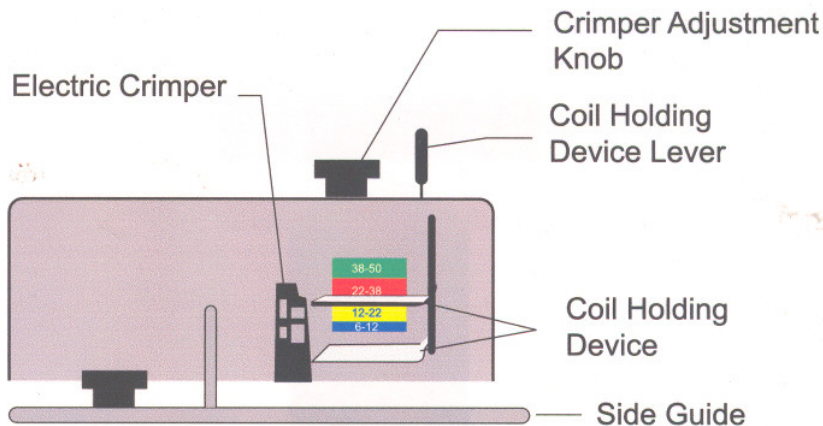

**Step 1** To adjust the crimper, use the adjustment knobs to enlarge or narrow the crimper according to the selected coil size.

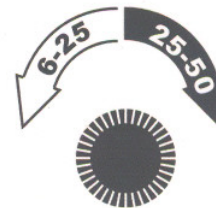
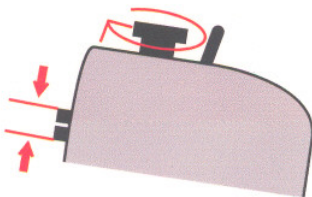

**Step 2** To adjust the worktable, use the adjustment knobs to raise or lower the worktable according to the selected coil size. Align the red indicator on the worktable to the lower limit of the coloured band of the coil size required.

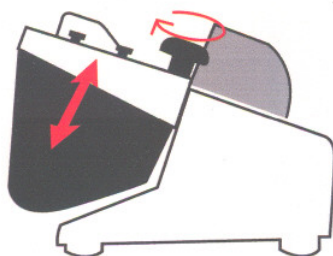

**Step 3** To adjust the coil holding device, using the lever and set the upper holder to the upper limit of the coloured band of selected coil size.

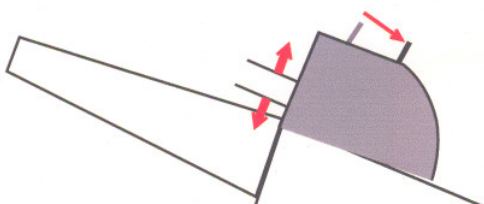

**Step 4** To adjust the book tray according to the selected book size.

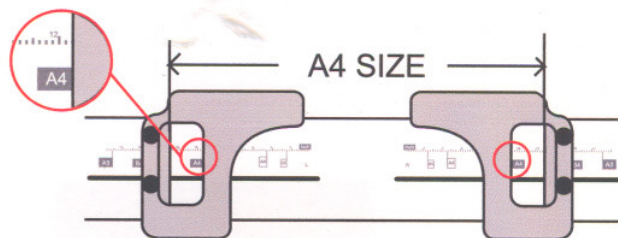

**Step 5** Place the book on the worktable and move the crimping unit to the end position.

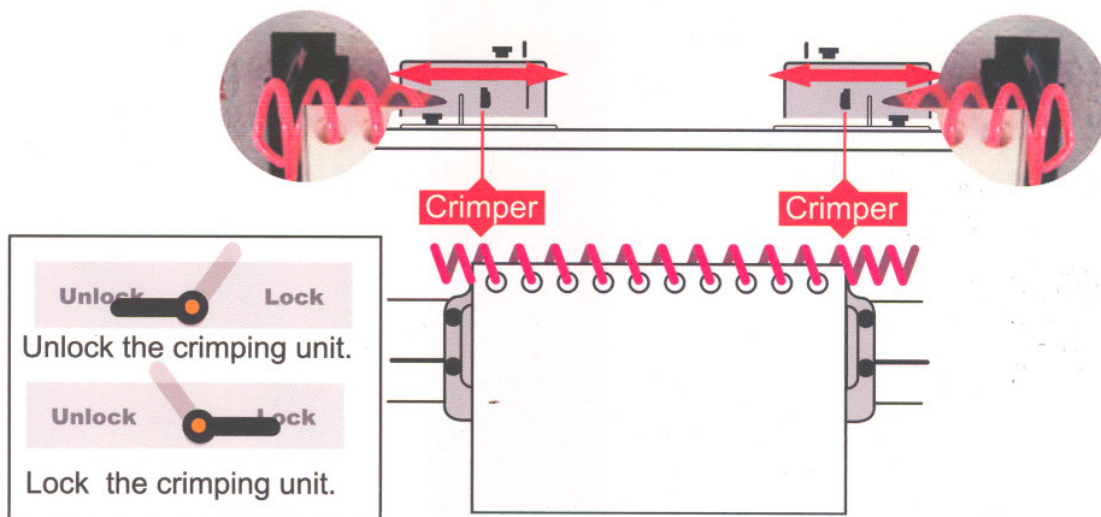

**Step 6** Make fine adjustment to the worktable, which allows the coil to be inserted smoothly and easily.

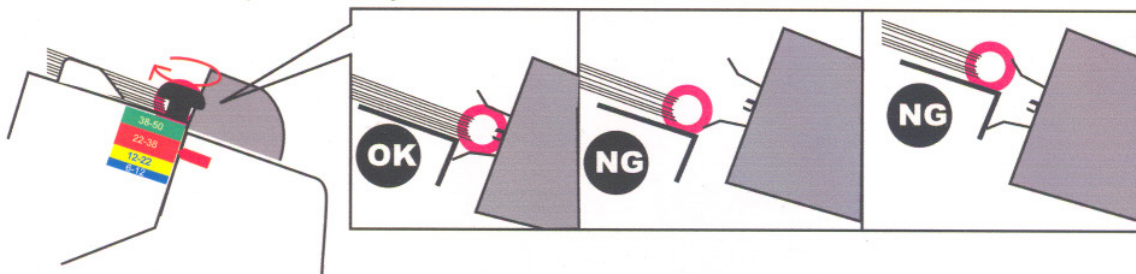

**Step 7** Move the book forward and backward and the book should move freely. Allow about 1mm space between the coil and coil holding device.

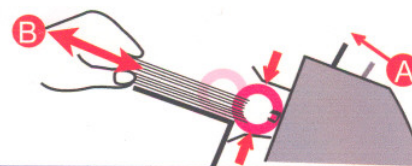

**Step 8** Place book on the worktable and press the foot pedal.

Hold the book with two hands and push the book forward till it stops

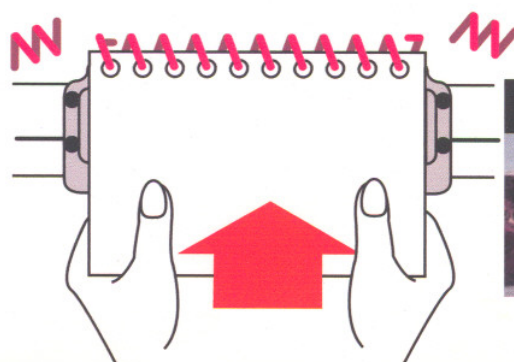



# Crimping Action Test

The situations below are caused by incorrect adjustments.

## 1. Improper cutting of the coil

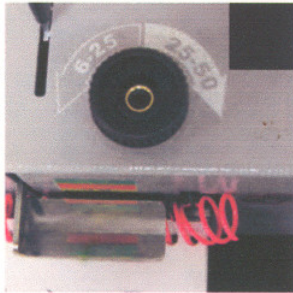

Action

- A . Check the crimper adjustment knob, it should be turn to the end position. **Step 1.**
- B . Push the book forward to the end position and held in position during the crimping action. **Step 8.**

## 2. Poor Crimping Quality

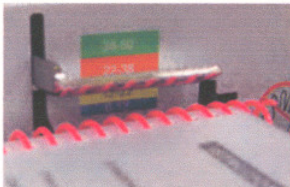

Action

- A . Check the position of the coil holding device. **Step 6 & 7.**

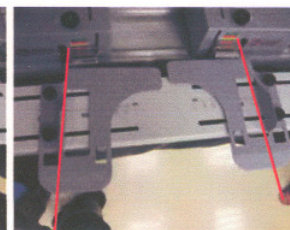
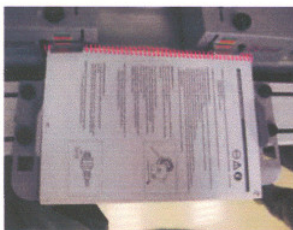

- B .Ensure the side guide is adjusted so that the book fits into the guide easily but without much left and right movement.

## Removal of the Coil Cut-Off

1. Turn off the power.
2. Remova the off-cut collection bag and clean the coil waste.
3. Place back the collection bag and turn on the power for proceeding.

# COIL BINDING EQUIPMENT

## CoilMac

A Manual Punch & Inserting machine  
for metal / plastic Spiral coil  
in Size 4:1, 5:1 or 6mm

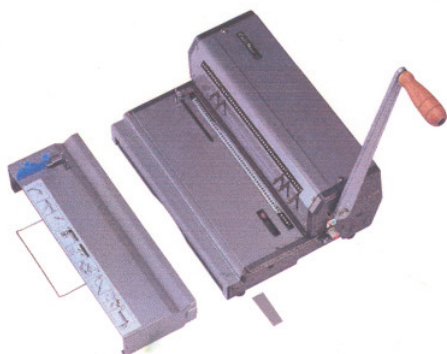

## CoilMac-ECI

A Manual Punch &  
Electric Coil Inserter  
for metal / plastic Spiral coil  
in Size 4:1, 5:1 or 6mm



## CoilMac-EPI

A Electric Punch &  
Electric Coil Inserter  
for metal / plastic Spiral coil  
in Size 4:1, 5:1 or 6mm

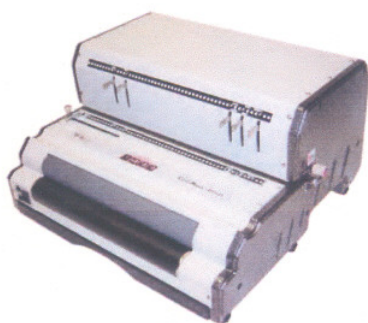

## RubiCoil

A Compact Punch & Binding machine  
for metal / plastic Spiral Coil  
in Size 4:1, 5:1 or 6mm pitch





# COIL BINDING EQUIPMENT



## CoilMac-ER

*Manual Punch And Electric Coil Inserter*

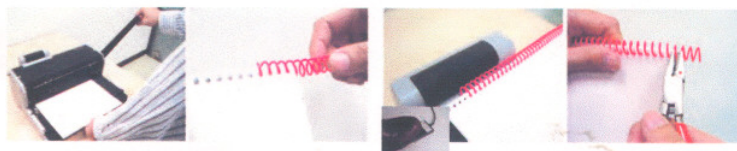

## Roll-@-Coil

*An Electric Coil Inserter  
for metal / plastic Spiral coil  
in All Sizes including 4:1, 5:1 or 6mm*



## Finish@Coil-M

*Electric Coil Inserter & Manual Crimpers*



## Finish@Coil-E1

*Electric Coil Inserter With Built-in Electric Crimper*

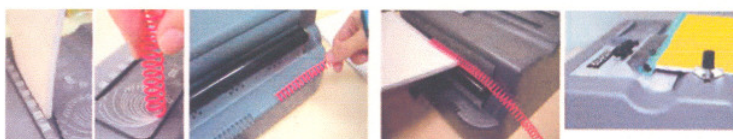

# TECHNICAL INFORMATION

*Crimp* @ *Coil*

## BINDING FORMAT

Legal (14" or 356 mm)  
Oficio (13" or 330 mm)  
A4 (11.69" or 297 mm)  
Letter (11" or 279 mm)  
A5 ( 8.27" or 210 mm)  
1/2 Letter (8.5" or 215.9 mm)

### SIZE 4:1

= 53 + 2 holes  
= 53 holes  
= 46 holes  
= 43 holes  
= 33 holes  
= 32 holes

### SIZE 6 mm

= 55 + 2 holes  
= 54 holes  
= 49 holes  
= 46 holes  
= 34 holes  
= 35 holes

### SIZE 5:1

= 65 + 5 holes  
= 65 holes  
= 59 holes  
= 55 holes  
= 41 holes  
= 42 holes

## CAPACITY & DIAMETER

No. Sheets (20 lbs)	DOCUMENT inch	DOCUMENT mm	COIL mm	No. Sheets (20 lbs)	DOCUMENT inch	DOCUMENT mm	COIL mm
25	1/8"	3.2 mm	5 mm	180	3/4"	19.0 mm	20 mm
35	5/32"	4.0 mm	6 mm	200	25/32"	19.8 mm	22 mm
45	3/16"	4.8 mm	7 mm	230	7/8"	22.2 mm	25 mm
60	1/4"	6.4 mm	8 mm	250	1 "	25.4 mm	28 mm
70	9/32"	7.2 mm	9 mm	280	1-1/16"	27.0 mm	30 mm
80	5/16"	7.9 mm	10 mm	300	1-1/8"	28.5 mm	32 mm
100	13/32"	10.3 mm	12 mm	350	1-5/16"	33.3 mm	38 mm
120	15/32"	11.9 mm	14 mm	400	1-9/16"	39.7 mm	45 mm
150	19/32"	15.0 mm	17 mm	450	1-7/8"	47.5 mm	50 mm