

# ***Akiles WireMac Manual Double Loop Wire Binding Machine***

## **Instruction Manual**

For Models:

**WireMac 2:1**

**WireMac 3:1**



*Provided by*

**MyBinding.com**  
*When Image Matters.*

**Call Us at 1-800-944-4573**

# WIREMAC OPERATION MANUAL

## INTRODUCTION:

CONGRATULATIONS ON THE PURCHASE OF YOUR NEW WIREMAC, A PROFESSIONAL AND HEAVY-DUTY WIRE PUNCH AND BINDING MACHINE. YOUR WIREMAC WAS DESIGNED WITH A FULL RANGE OF FUNCTION AND PREMIUM QUALITY COMPONENTS TO GUARANTEE YOU AN EFFORTLESS AND PROFESSIONAL BIND, AS WELL AS MANY YEARS OF TROUBLE-FREE SERVICE.

## IMPORTANT:

WE RECOMMEND THAT YOU TAKE A FEW MINUTES TO FAMILIARIZE YOURSELF WITH THE FUNCTIONS OF YOUR NEW WIREMAC. YOU WILL FIND THAT WITH JUST A LITTLE PRACTICE, ANY PERSON CAN ACHIEVE PROFESSIONAL RESULTS.

## WARRANTY:

YOUR WIREMAC HAS A ONE YEAR WARRANTY, FROM ITS PURCHASE DATE. IN THE EVENT OF A MANUFACTURERS DEFECT, YOUR DISTRIBUTOR MAY REPAIR OR REPLACE IT. IMPORTANT: THIS WARRANTY DOES NOT COVER DAMAGES DUE TO IMPROPER USE OR MISTREATMENT OF THE UNIT, INCLUDING ANY EXTRAORDINARY EVENT LEADING TO DAMAGE OF THE MACHINE, WHETHER IT IS REVERSIBLE OR NOT.

IF THE WIREMAC IS NOT OPERATING PROPERLY, FIRST FOLLOW THE OPERATIONAL MANUAL INSTRUCTIONS. IF THE PROBLEM PERSISTS, PLEASE CONTACT YOUR DEALER FOR FURTHER INSTRUCTIONS. PLEASE HAVE YOUR MACHINES SERIAL NUMBER AND THE PURCHASE DATE READY. IF THE MACHINE MUST BE RETURNED TO YOUR DISTRIBUTOR, IT IS YOUR RESPONSIBILITY TO PROPERLY PACK AND SHIP IT. AS ANY DAMAGES INCURRED DURING ITS TRANSPORTATION ARE NOT COVERED BY OUR WARRANTY POLICY.

## FEATURES

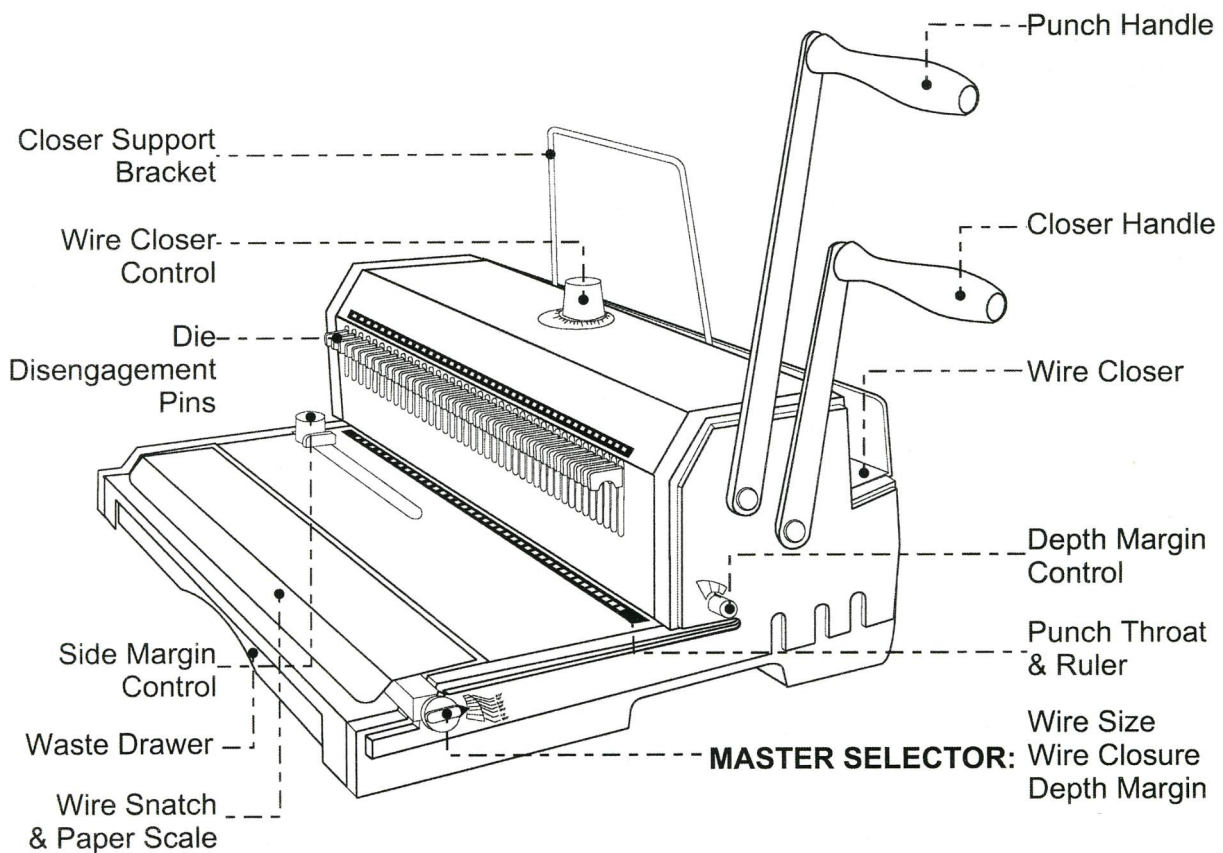

# ASSEMBLY

Place Your New WireMac  
On top Of A Sturdy Working Table.

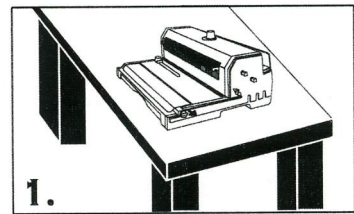

Remove The Screw From Punching Axle  
Connect The Punch Handle ( The Longer One)  
In A Vertical Position Onto The Punching Axle.  
Tighten-Back The Screw Onto The Punching Axle.

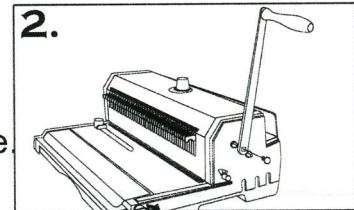

To Set-Up The Closer Handle  
Repeat Above Steps With Closer Axle  
& Handle

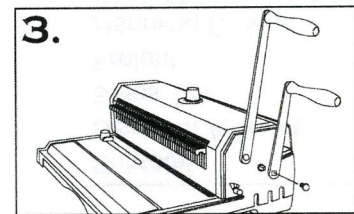

# SET-UP

Insert Your Full Unbound  
Document Into  
Wire Snatch.

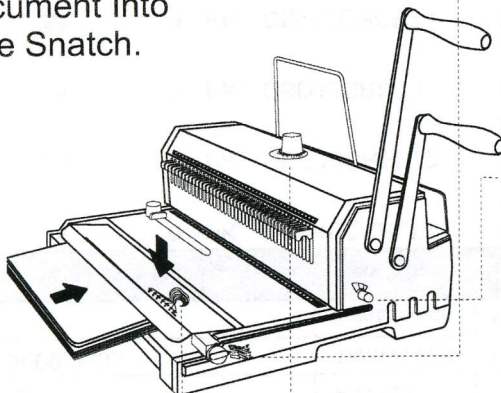

Read The Master Selector  
To Determine The Correct:  
Depth Margin  
Wire Size  
Wire Closure

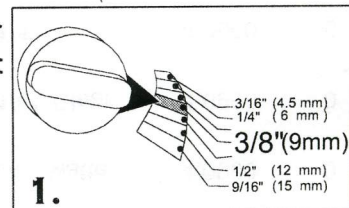

Set Margin Control To  
The Color Determine  
Depth Margin.

(Color Indicated On Master  
Selector Should Match Color  
On Margin Control)

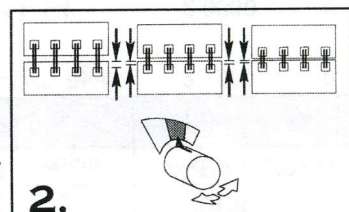

Set Wire Closer Control  
To The Determined  
Wire Closure Size.

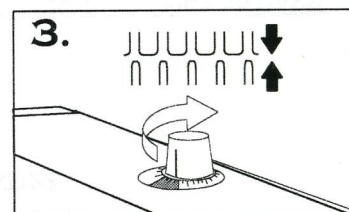

Read The Determined  
Wire Size And Set Aside.

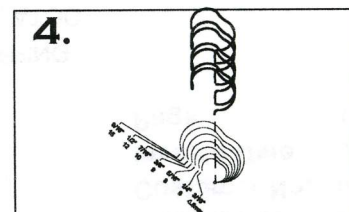



# PUNCHING

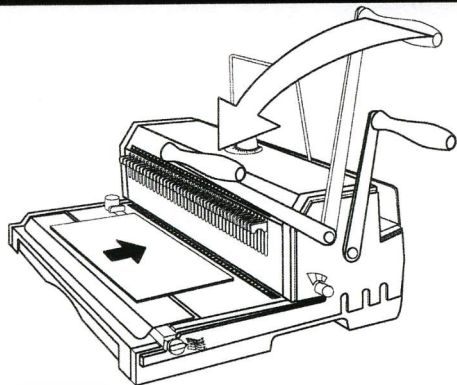

Move Side Margin Control To Proper Sheet & Cover Size.

Note There Are Different Side Margins For 11" Sheets & Their 11-1/4" Covers.

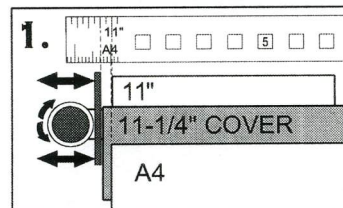

## TIPS

Maximum Single Punching:  
20 Sheets Of 20 Lbs  
or 70-80g/m Paper.

Comfortable Single Punching:  
12-15 Sheets Of 20 Lbs  
or 70-80 g/m Paper.

Punch Inner Sheets And  
Cover Separately As Side Margin  
May Vary.

Re-Align ( Center) Margins  
For Oversize Covers.

Pull Out Disengagement  
Pins For Partially Covered  
Holes.

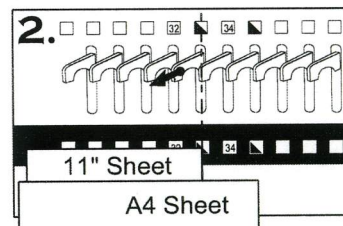

Insert Sheets And  
Pull Handle Forward  
To Punch.

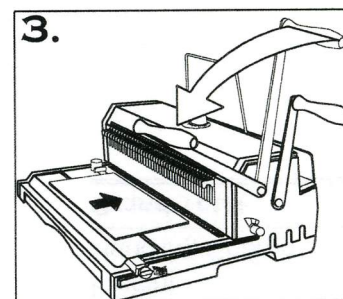

# INSERTING

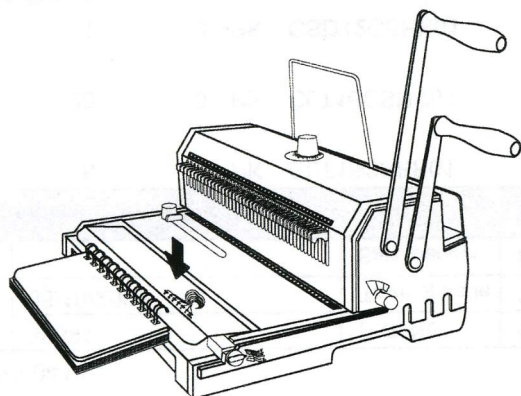

Insert Pre-Selected Wire  
Into Wire Snatch

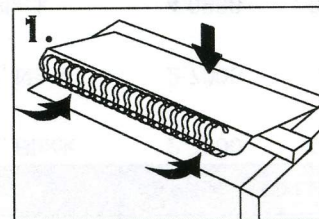

Insert Document From  
Last Pages To First  
Pages Then Insert Front  
Cover.  
The Back Cover Should  
Be Inserted Last With  
Inside Facing Up.

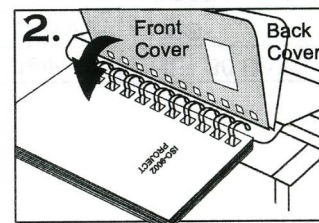

## TIPS

The Seam Of Closed Wire Should Be Inside The Book.  
Follow Step No.2 Instruction For Best Results.

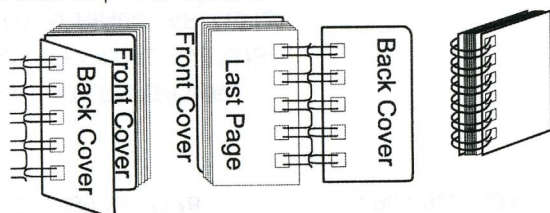

Take Out Inserted  
Document From  
Wire Snatch To  
Close The Wire.

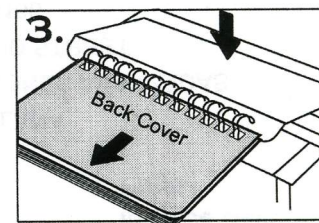

# CLOSING

Raise Up Closer Support Bracket To Hold Document.

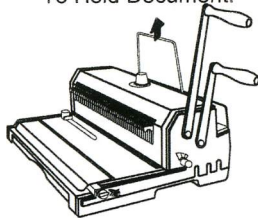

Put Inserted Document Into Wire Closer.

The Wire Element Must Stand Horizontally At The Bottom Of Closer.

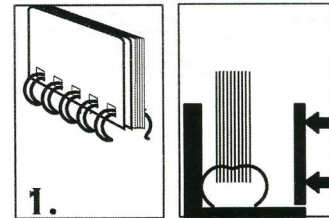

## TIPS

The Seam Of Closed Wire Should Be Just Touching. Slightly Adjust The Closer Control For The Under-Closed Or Over- Closed Seam.



Properly Closed

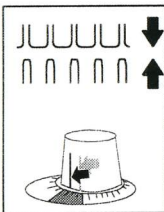

Under Closed.  
Adjust Control  
Clockwise A  
Few Grids.

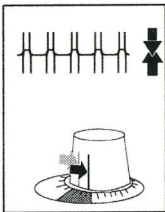

Over Closed.  
Adjust Control  
Counter-Clockwise  
A Few Grids.

Pull Closer Handle Forward To Close.

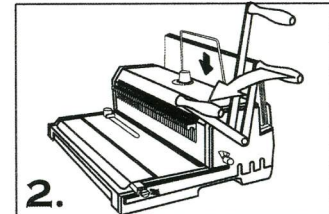

Take Out Document And Turn Back Cover Over. The Binding Is Ready.

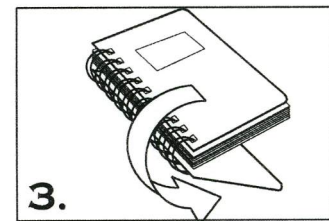

# TECHNICAL INFORMATION

Model	WIREMAC 31 Pitch 3 : 1			WIREMAC 21 Pitch 2 : 1		
	■ ■ ■ ■ ■ ■ ■ ■			■ ■ ■ ■ ■		
Punching Length	14" = 40 Holes LEGAL = 38 Holes A4 = 34 Holes 11" = 32 Holes 8.5" = 24 Holes A5 = 24 Holes			14" = 27 Holes LEGAL = 26 Holes A4 = 23 Holes 11" = 21 Holes 8.5" = 16 Holes A5 = 16 Holes		
Binding Capacity	Sheets 70-80 g/m <sup>2</sup> 20 30 50 60 80 100 120	Diameters Inch mm 3/16" 4.5 1/4" 6 5/16" 8 3/8" 9 7/16" 10 1/2" 12 9/16" 15		Sheets 70-80 g/m <sup>2</sup> 140 160 190 220 280	Diameters Inch mm 5/8" 16 mm 3/4" 19 mm 7/8" 22 mm 1" 25 mm 1-1/4" 32 mm	