

Formax FD 8650HS Level 6 Cross-Cut Paper Shredder

Instruction Manual



Provided by

MyBinding.com
When Image Matters.

Call Us at 1-800-944-4573

Safety Devices and Other Features

Formax 8000 Series Shredders are equipped with various safety features:

Automatic Reverse Rotation

When too much paper is inserted, the cutter stops operating and automatically rotates in reverse to discharge the jammed paper. An alarm sounds. Reduce the amount of paper and restart the operation.



Door Switch

If the door is open, the shredder will not operate.

Automatic Stop

When the shredded paper fills the wastebasket, the "FULL" light comes on and the cutter stops operation. Open the door, remove the wastebasket and empty paper scraps. Replace the wastebasket, close the door and continue operation.



Automatic Power Shut-Off

- If the shredder operates continuously for more than 30 minutes, the power is automatically shut off.
- If the motor is overloaded, the "STOP" LED will flash until it cools down. When the flashing stops the shredder is ready to be used again.



Maintenance

- Disconnect power by pulling power cord plug from wall outlet.
- To clean the exterior, wipe the surface with a soft cloth. If the surface is very dirty, use a neutral detergent, then wipe again with a soft cloth.

CAUTION:

- Never put water directly on the surface of the shredder.
- Never clean the case with benzene or thinner, since it will cause discoloration.
- Do not dismantle the shredder. Contact your Formax Dealer for service.

MyBinding.com
5500 NE Moore Court
Hillsboro, OR 97124
Toll Free: 1-800-944-4573
Local: 503-640-5920

FORMAX®

FD 8650HS High-Security w/AutoOiler Cross-Cut Paper Shredder



NSA Approved: Meets the requirements of NSA/CSS specification for Level 6 High-Security cross-cut shredders.

7/2011

OPERATOR MANUAL
FIRST EDITION

Specifications

Cutting Style:	Cross Cut
Shred Size:	1/32" x 3/16" (Level 6)
Sheet Capacity:	14 - 15 sheets*
Speed:	Up to 24 feet per minute
Feed Opening:	16"
Dimensions:	28" W (includes oil reservoir) x 24" D x 43" H
Security Level	Level 6 (HIPAA Compliant)
Bin Capacity:	53 gal.
Weight:	319 lbs
Power supply:	110V, 50/60Hz 20A
Does not accept credit cards, staples or paper clips	
* Capacity varies depending on paper and power supply	

Set-up Guidelines

1. Install the shredder on a level surface, away from heat sources and direct sunlight.
2. Insert plug into wall outlet with the appropriate voltage, 110V. If the outlet is shared with another electronic device, the total current should not exceed 30A (at 110V).

Operation

1. Flip the power switch "ON" located on the right side of the shredder.

2. Auto Start/Auto Stop

When the "START" button is pushed, the signal lamp "AUTO" will light. Insert paper to shred. The shredder will start and stop automatically when using this function.

3. Manual Operation

If paper is too small for the shredder's sensors to detect, shred it manually. Push the "START" button once more and the "MANUAL" lamp will light. Insert paper to be shredded. Three minutes after shredding, the cutter automatically stops rotating.

4. Reverse Operation

Push the "REV" button and the signal lamp "REV" will light and cutters will operate in reverse. If too much paper is inserted at one time in standard modes, the shredder will automatically operate in reverse. If this occurs, remove the inserted paper and shred in smaller amounts. NOTE: The maximum amount of paper to be shredded differs according to paper quality, humidity and voltage. If the shredder is to be used continuously, do not insert more than half of the maximum capacity.

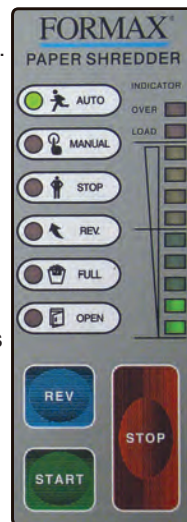

5. Full Sensor

If the wastebasket is full, the "FULL" lamp will light and the cutter will stop automatically. Open the door, empty the wastebasket of paper strips/chips, replace the wastebasket, close door, and continue to shred.

AutoOiler

The AutoOiler periodically pumps oil onto the cutting blades for optimal performance.

To install oil reservoir bottle, unscrew and remove cap from full bottle of oil, insert hose into the top of the bottle, and screw on cap.

The oiler is now ready for use.

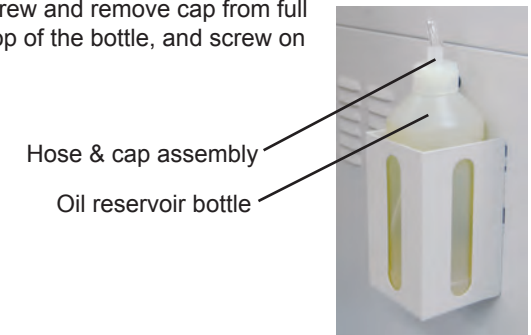

Safety Precautions

To avoid personal injury, and damage to the shredder, observe the following safety precautions. Please keep these instructions for future reference.

NOTE: In case of emergency, flip the "Power Switch" to cut off power and/or pull the plug out of the wall outlet.



- Keep hands, long hair, clothing, ties, jewelry and loose items away from the feed opening and shred outlet.
- Do not use the shredder for anything other than its intended purpose. Never use it to shred cloth, plastic, cardboard or any hard material that will cause damage to the shredder blades.
- Do not allow children to use the machine.
- Do not operate with a damaged power cord or plug, or when the machine is damaged in any manner.
- Unplug the shredder when it is being moved, or if it is not in use for an extended period of time.
- Do not disconnect the power by pulling only the cord. Hold the plug when disconnecting.
- Keep the shredder away from direct sunlight.
- Do not sit on the shredder or place anything on top of it.
- Never open the fixed switch or cover.

MyBinding.com
 5500 NE Moore Court
 Hillsboro, OR 97124
 Toll Free: 1-800-944-4573
 Local: 503-640-5920