

# ***Luxor RECLAIM Clear Acrylic 30" x 30" Clamp-On Sneeze Guard Cubicle Wall Extender***

## **Instruction Manual**



*Provided by*

**MyBinding.com**  
*When Image Matters.*

**Call Us at 1-800-944-4573**

# DIVWT 2 Clamp Wall Top Divider Panel Assembly Guide

## Part List

**Tools Needed:**  
Allen Wrench  
(Included)  
Screw Driver  
(Not Included)

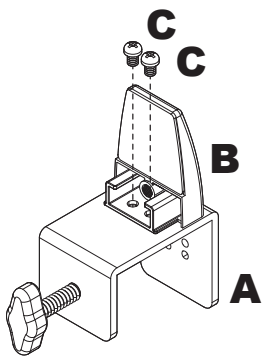
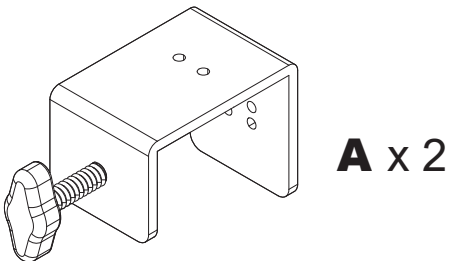
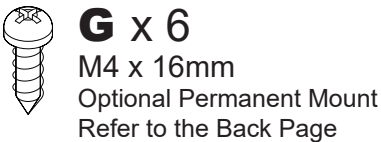
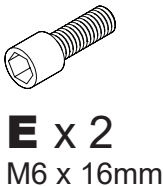
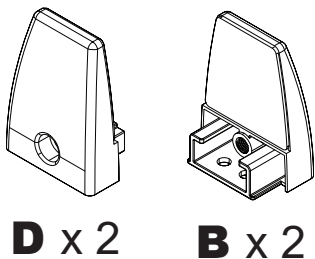
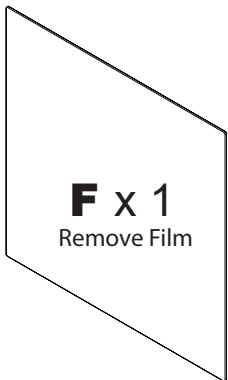

**①**  
Attach B to A with Screws C

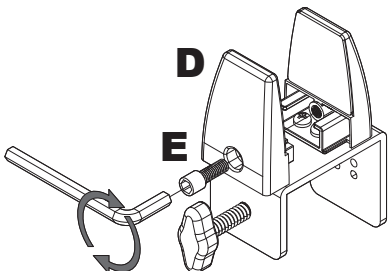

**②**  
Attach D with Screw E

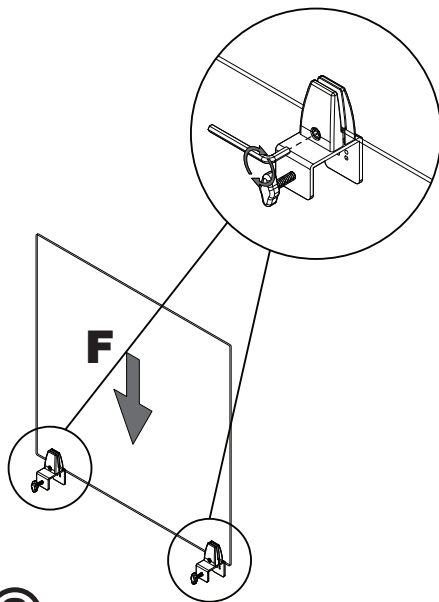

**③**  
Install F into Assembled Clamps  
Tighten Clamps

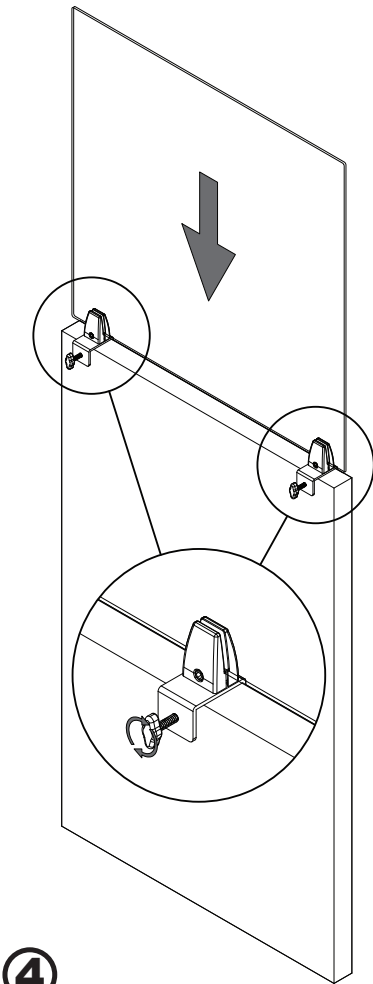

**④**  
Install Divider Panel onto Wall  
Tighten Clamps to Wall

# DIVWT 2 Clamp Wall Top Divider Panel Assembly Guide

## Optional Permanent Mount

**Tools Needed:**  
Allen Wrench  
(Included)  
Screw Driver  
Pencil  
(Not Included)

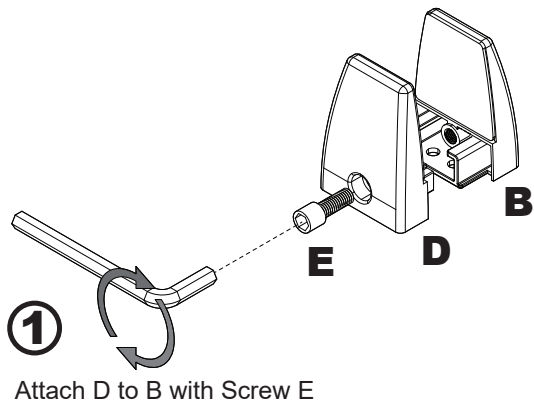
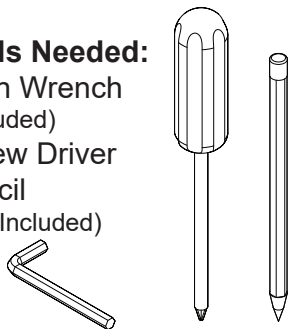

① Attach D to B with Screw E

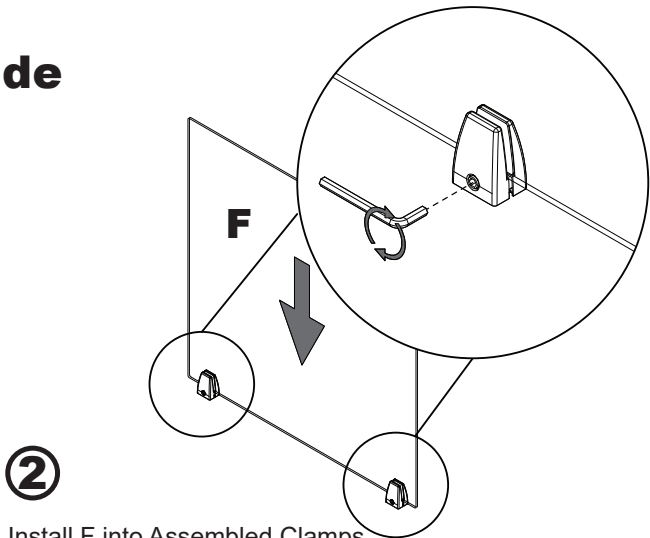

② Install F into Assembled Clamps.  
Tighten Clamps.

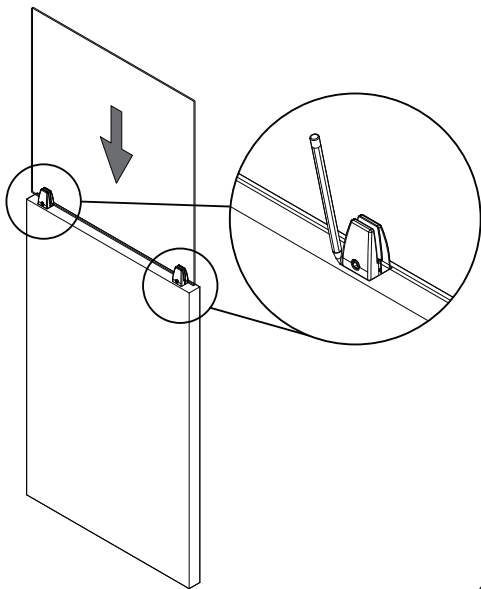

③

With Assistance - Place the Panel Assembly on the Wall and Outline the Clamps with a Pencil.

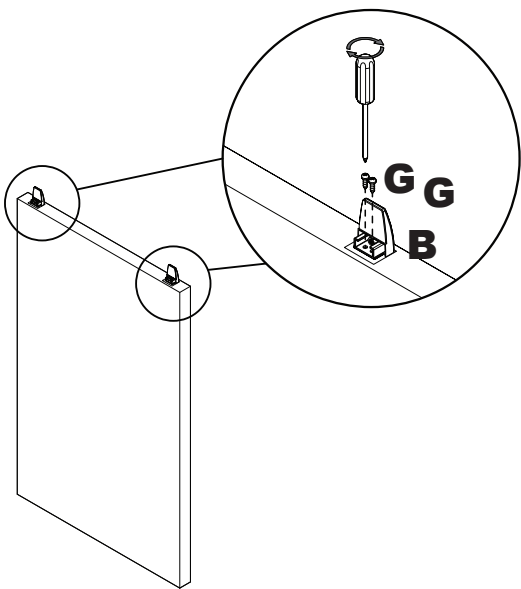

④

Remove and Disassemble the Panel Assembly. Place Part B on the Wall in the Outline Location and Secure with Screws G.

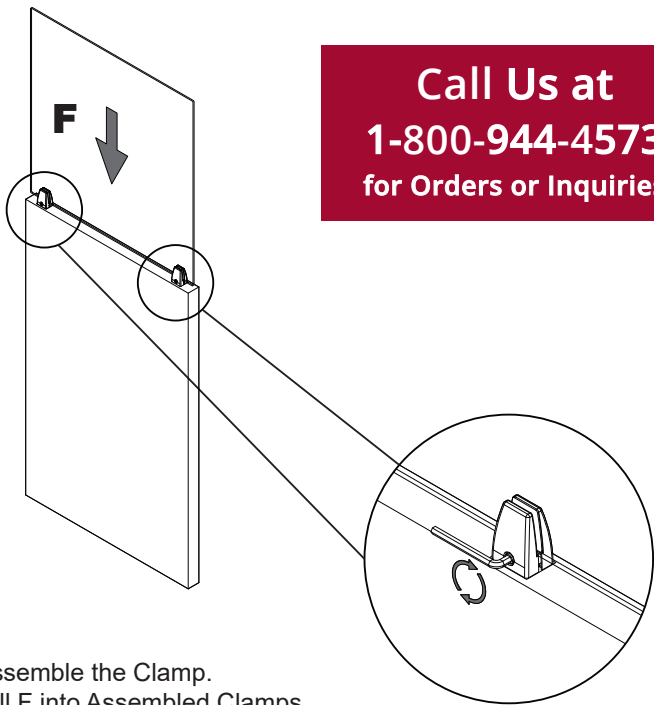

④

Reassemble the Clamp. Install F into Assembled Clamps. Tighten Clamps.

**Call Us at**  
**1-800-944-4573**  
for Orders or Inquiries