

# ***Luxor Adjustable Height Flat Panel Stand with Shelf - FP2500***

## **Instruction Manual**



**MyBinding.com**  
When Image Matters.

Call Us at 1-800-944-4573

# Flat Panel Cart Assembly Guide

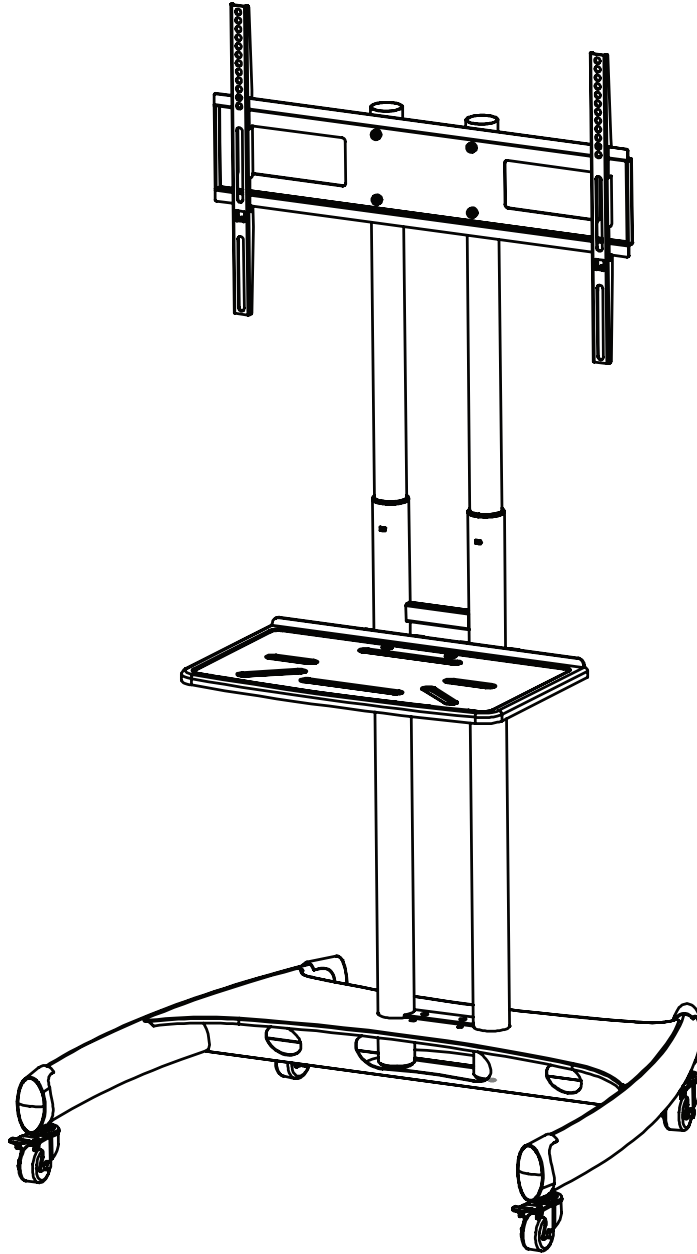

## Adjustable Height Flat Panel TV Cart with Media Shelf

Designed for 32"-65" TV Panels

VESA: 100 x 100 - 600 x 400

Max Load Capacity: 100 lbs

Media Shelf Max Load: 10 lbs

Table of Contents

Table of Contents and Warnings ..... 2

Part List ..... 3

**Assembly and Installation**

1. Installing the Casters and Poles ..... 4

2. Adjusting the Pole Height ..... 5

3. Installing the Media Shelf ..... 6

4. Installing the TV Mount ..... 7

5. Selecting the VESA pattern ..... 8

6. Attaching the TV to the Cart ..... 9

7. Cable Management ..... 10

Tools Required

- Phillips Screwdriver
- Tape Measure
- Wrench



WARNING!











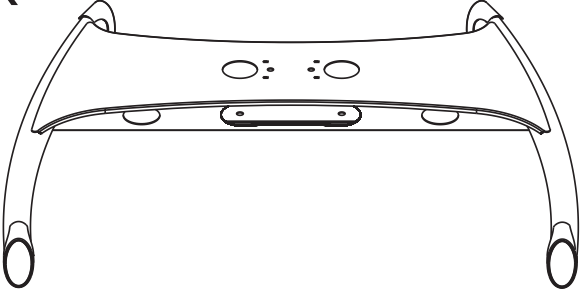
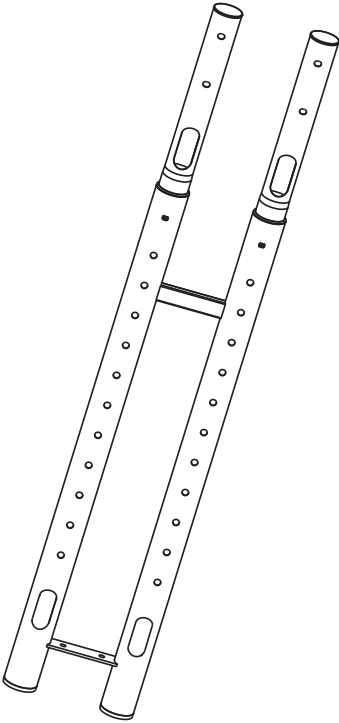
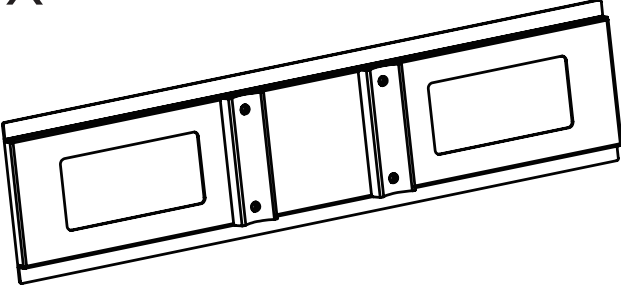
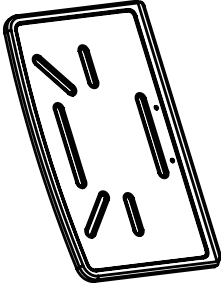

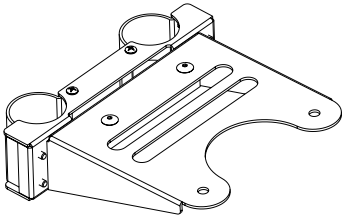
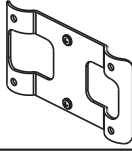
Severe personal injury and property damage can result from improper installation. Read instructions carefully before beginning.

- ☒ Assistance is required when installing the TV.  
If you do not understand the instructions or have any concerns please contact a qualified local installer.
- ☒ Do not install or assemble if the product or hardware is damaged or missing, if you require replacement parts, contact your local dealer.
- ☒ This product fits most 40" - 60" flat panel displays; maximum weight for the display is 100 lbs.
- ☒ Do not use this product for anything other than what it was originally designed.
- ☒ This product contains moving parts, please use caution.
- ☒ The manufacturer disclaims any liability for the modifications, improper installation, and installation exceeding maximum weight capacity. The manufacturer will not be liable for any damages arising out of the use of, or inability to use the product.

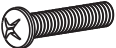
Visual Guides

Tighten	Loosen	Phillips Screwdriver	Tape Measure	Adjustment	By Hand	Hex Wrench

Parts List

1X 		1X 		
1X 				
1X 	2X 	1X 	1X 	4X 
		1X 		
A 4X  M8×25mm	B 4X  M6×25mm	C 4X  M5×25mm	D 4X  Φ16×Φ6.2×1.5mm	E 4X  Φ18×8 ×H10mm
F  NOT USED	G 4X  M8×20mm	H 1X  M5	I 4X  M8×60mm	J 1X  M4

## 1.1 Install casters to base

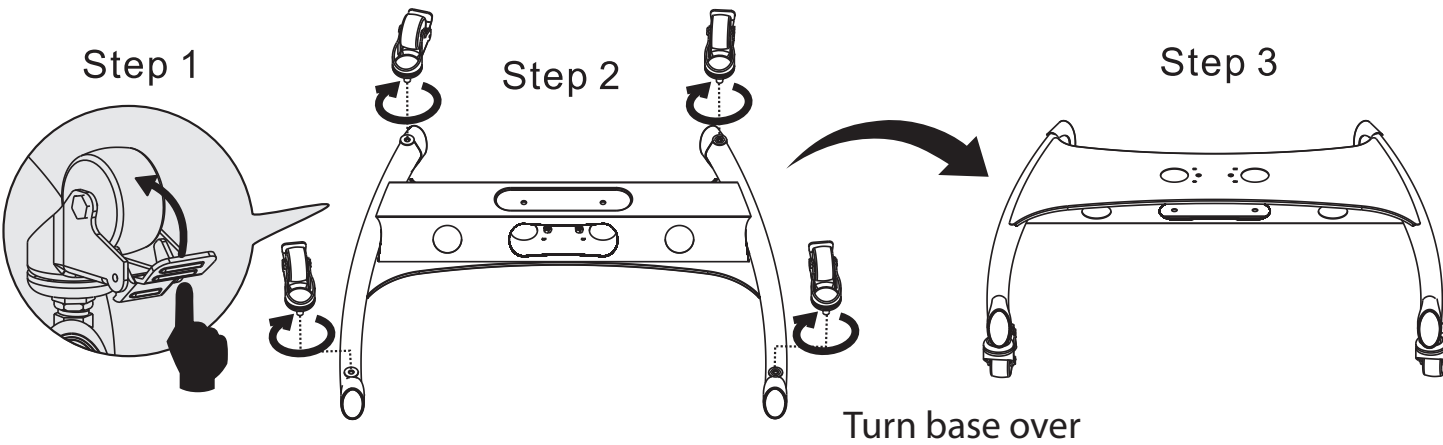

## 1.2 Install poles to base

Note:  
Make sure the cable management  
holes are facing the rear of the base

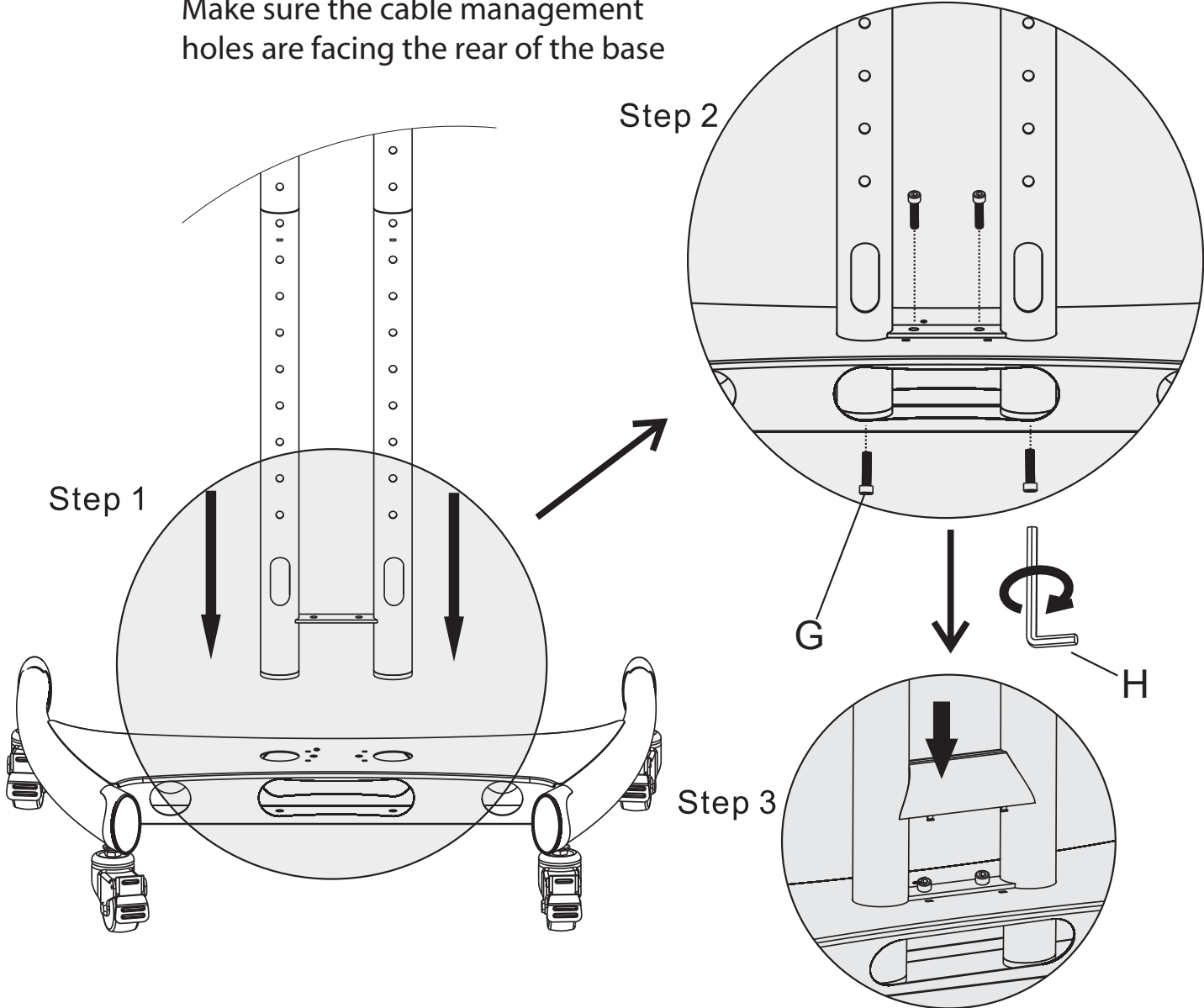

## 2. Adjust the height of the telescopic mounting poles

- Step 1. Using your thumb or finger, depress the right upper pole spring plunger ball located at the cable window, and twist the upper pole 90 degrees. Pull the upper pole to your desired height, twist the upper pole toward the plunger holes, and engage the spring ball into the plunger hole and set as shown in Figure1.
- Step 2. Repeat with the left pole.

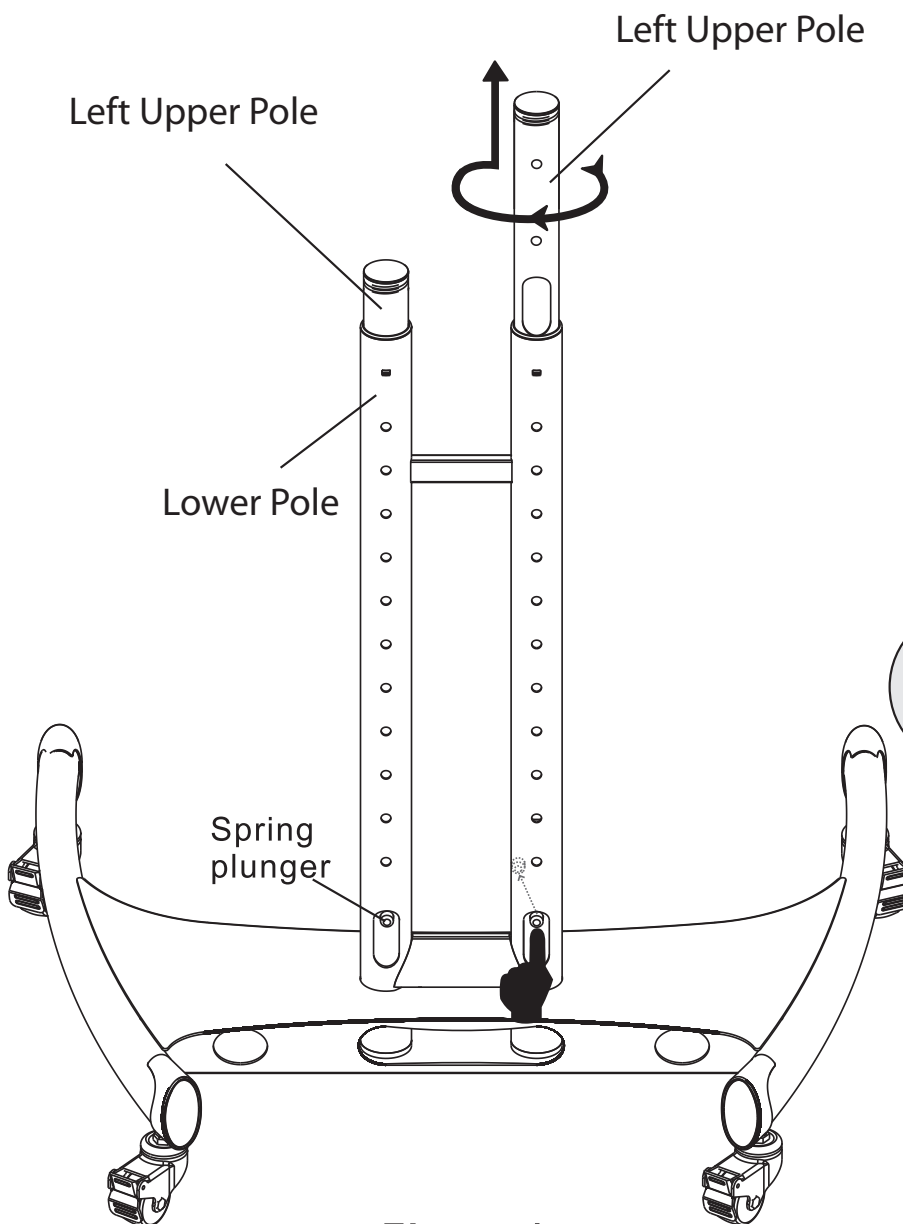

**Figure 1**

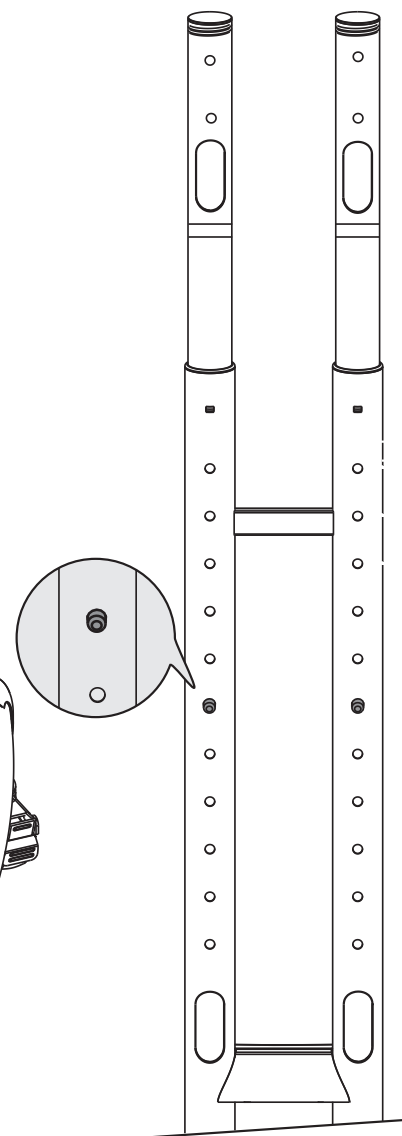

**Figure 2**

### 3. Install the media shelf

#### Remove Pre-Installed Screws

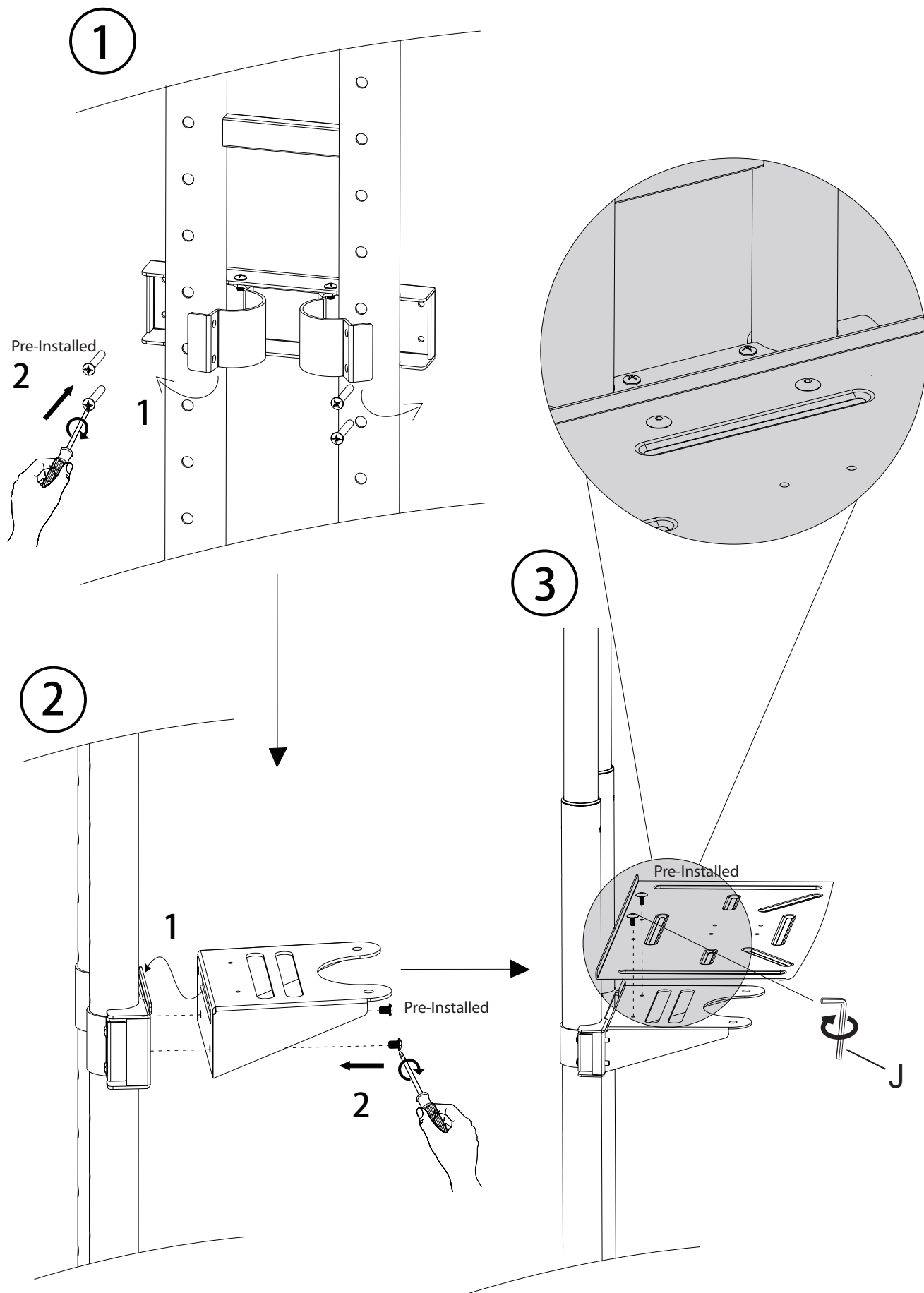

4. Install the TV mount

Step 1

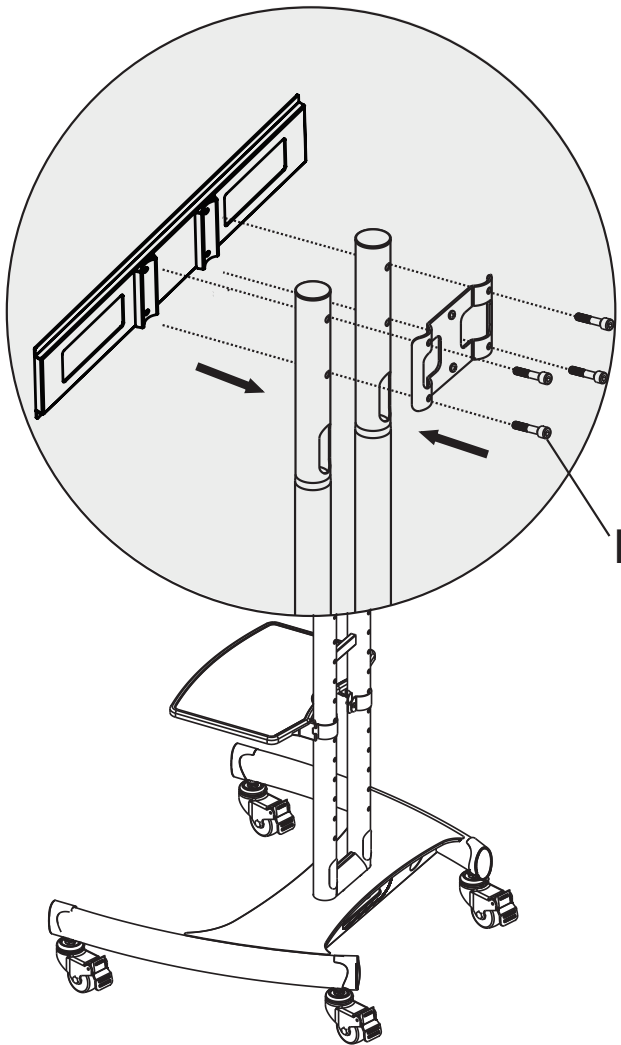

Step 2

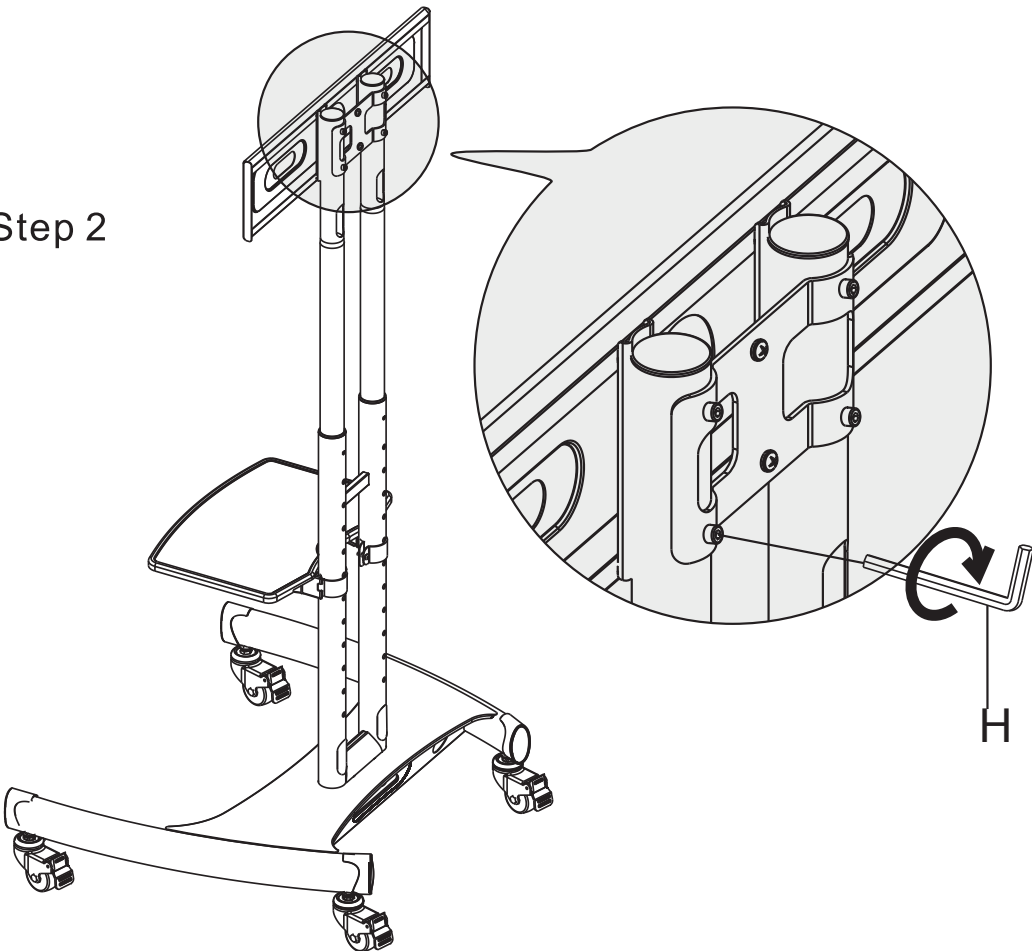



# 5. Select your VESA pattern and attach TV brackets

VESA: 100x100~600x400mm

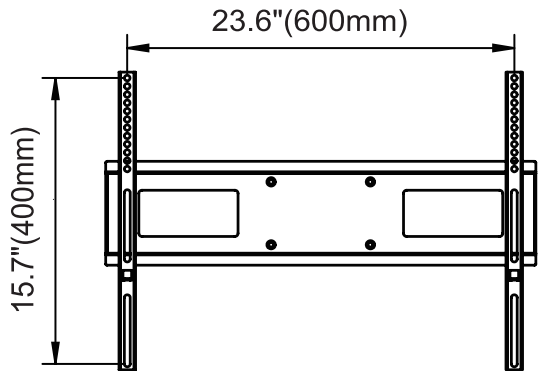
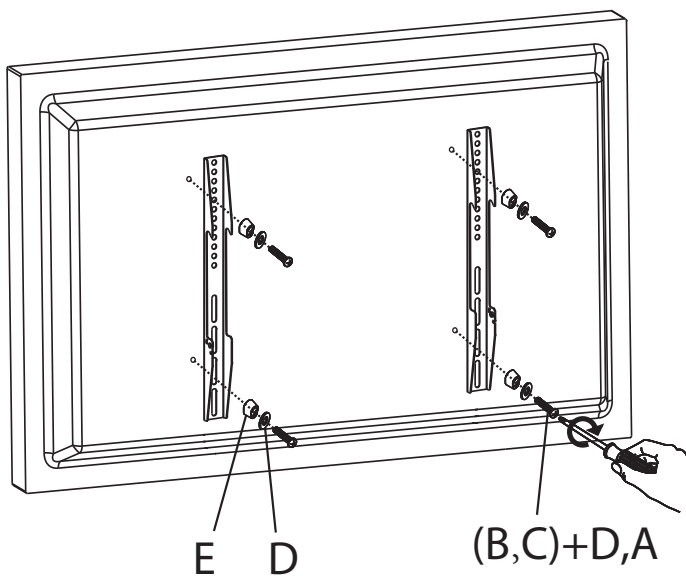
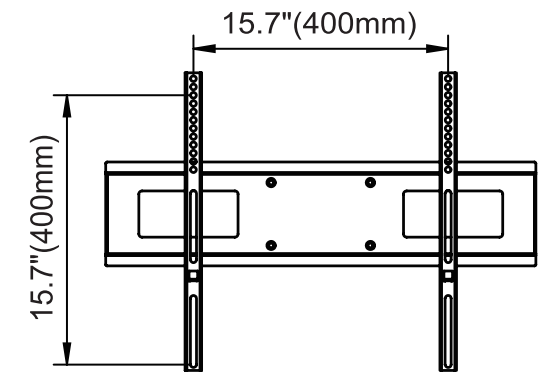
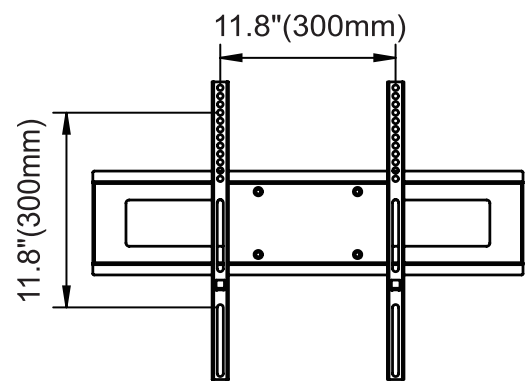
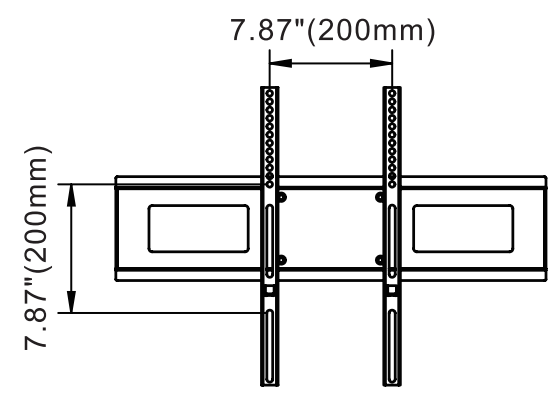
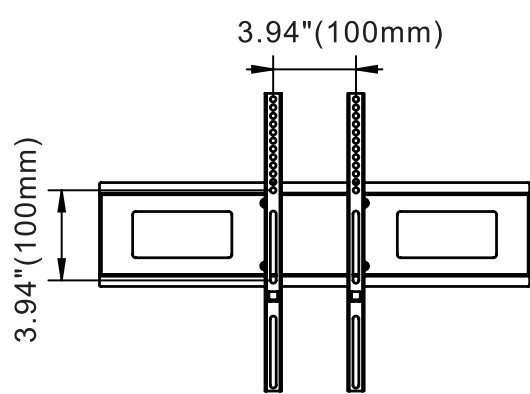

**Note:**  
To avoid damage, a spacer must be used when the mounting hole is minimal.

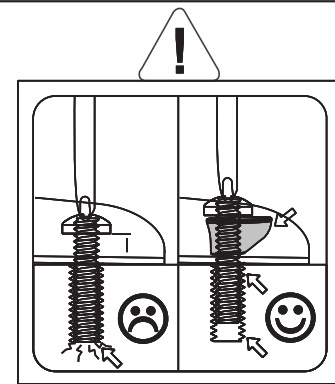
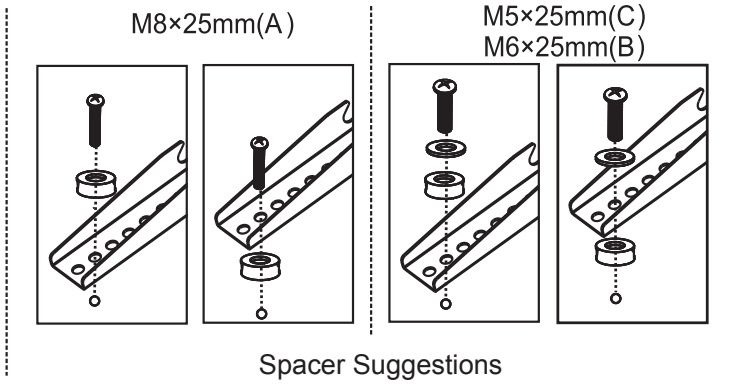

6. Mounting TV to TV mount - Assistance Required!

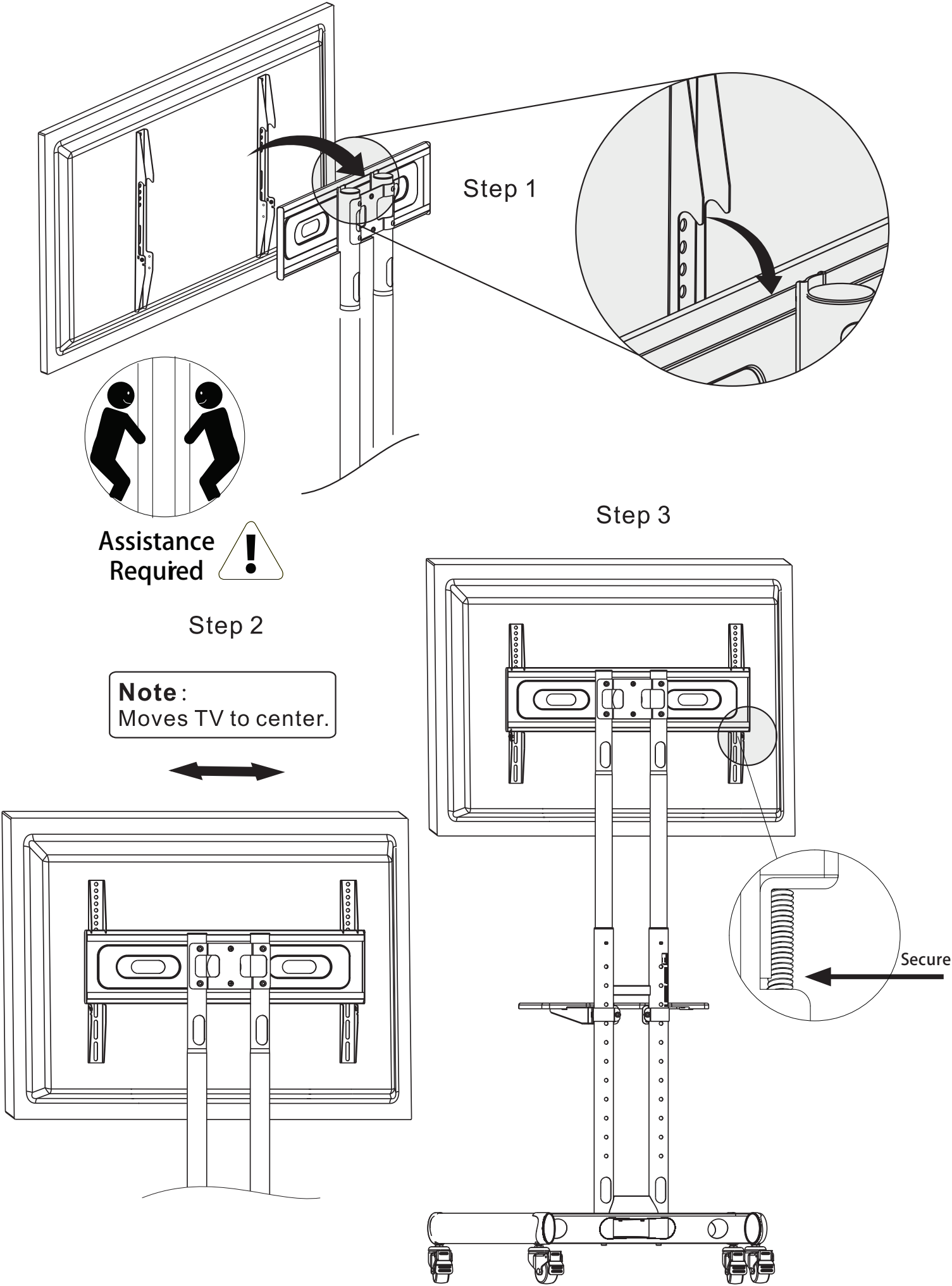

# 7. Cable Management

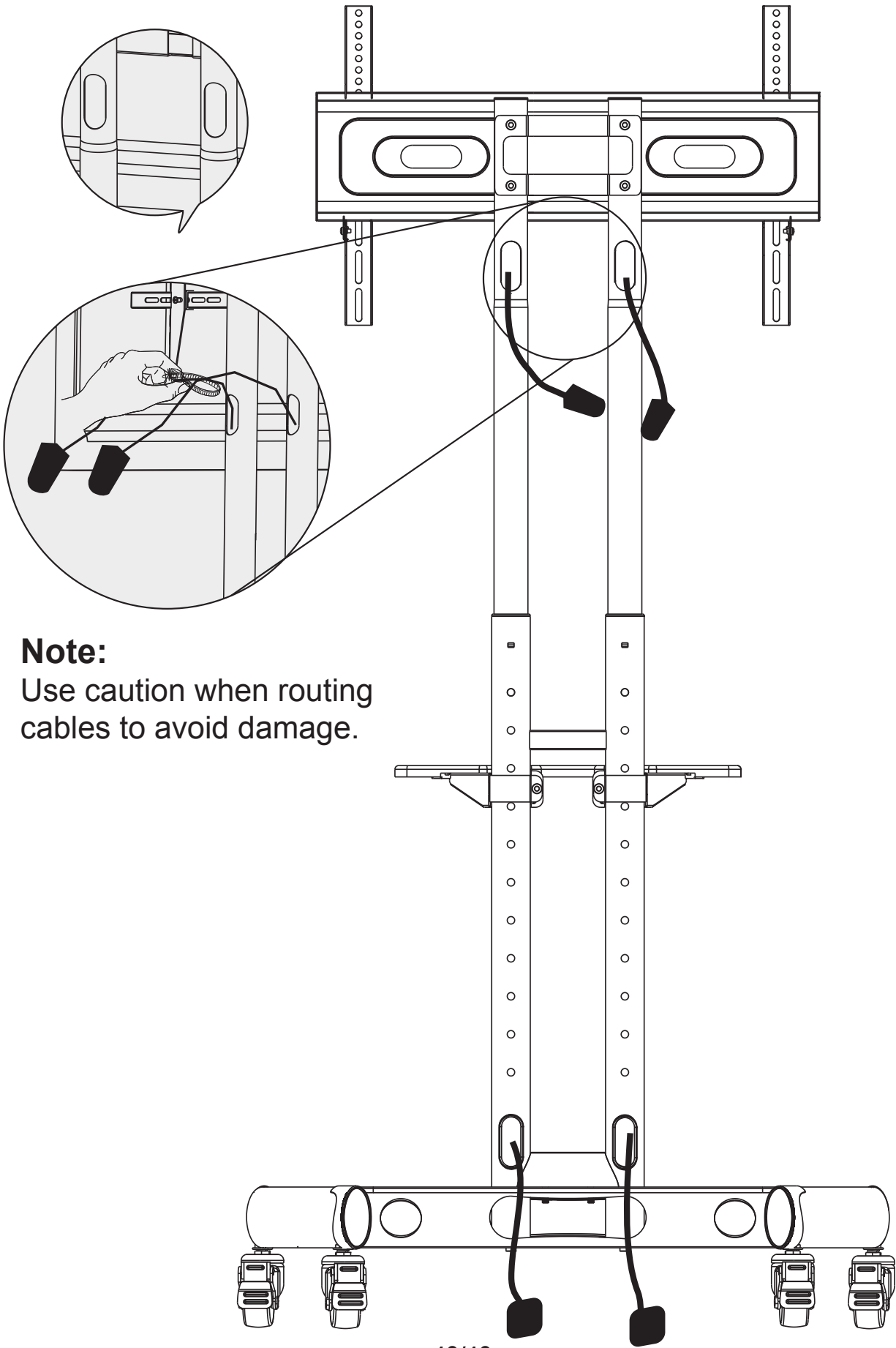

**Note:**  
Use caution when routing  
cables to avoid damage.