

# ***MINIWIRE Manual 3:1 Pitch Wire Binding Machine***

Instruction Manual



*Provided by*

**MyBinding.com**  
*When Image Matters.*

Call Us at 1-800-944-4573

MINIWIRE	Specifications
Punching Capacity	10 sheets (20 lb paper) or 2 sheets of plastic covers
Binding Size	3/16" to 9/16"
Pitch	3:1
Number of Holes	32 Holes
Format	Letter
Depth Margin	Adjustable
Side Margin Guide	Adjustable
Machine Dimensions	15" x 10.5" x 5"
Weight & Volume	14 lbs & 0.41 CbFt
Warranty	2 Years

## WARRANTY POLICY

YOUR **MINIWIRE** HAS A WARRANTY OF 2 YEARS FROM DATE OF PURCHASE. IN THE EVENT OF A MANUFACTURER'S DEFECT, MY BINDING WILL REPAIR OR REPLACE IT. IMPORTANT: THIS WARRANTY DOES NOT COVER DAMAGES DUE TO IMPROPER USE OR MISTREATMENT OF THE UNIT, INCLUDING EXTRAORDINARY EVENT LEADING TO THE DAMAGE OF THE MACHINE, WHETHER IT IS REVERSIBLE OR NOT.



# MINIWIRE

*Wire Binding Machine*

## OPERATIONAL MANUAL



## FEATURES

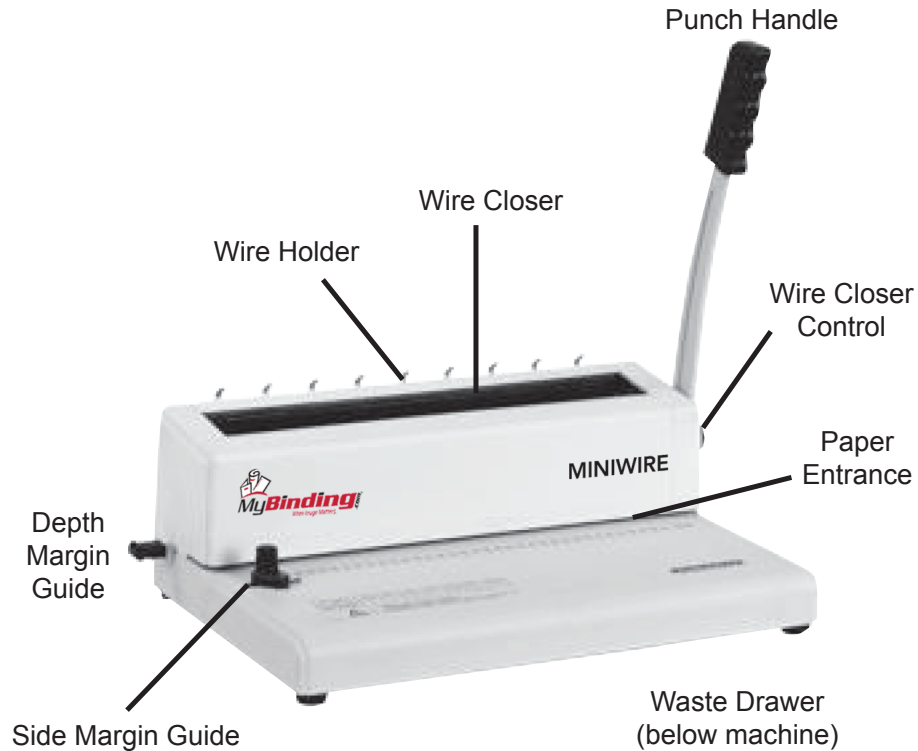

## ASSEMBLY

- 1) Place your **MINIWIRE** on top of a sturdy table.
- 2) Install Punch Handle and tighten screw.

## PUNCHING

1. Use Depth Margin Guide to set the preferred punching margin.
2. Move the Side Margin Guide to center the holes on your documents.
3. Insert the documents (10 sheets of 20lb paper max) and press down on the Punch Handle to punch holes, then release back to original position. Repeat Step 3 as needed.

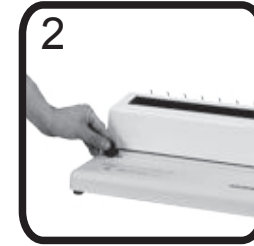
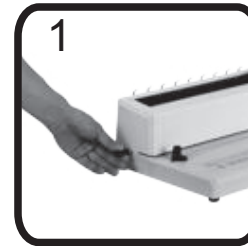

## BINDING

4. Place the wire on the Wire Holder with the opening facing upward (not shown).
5. Insert punched documents into the wire.
6. Rotate the Wire Closer Control to the correct wire size.
7. Place the inserted documents in the Wire Closer with the wire opening facing down. Press down on the handle and release back to original position. Remove document from the Wire Closer. You now have a wire bound book.

