

Stanley Bostitch Heavy Duty Flat Clinch Stapler - BOSB380HDBLK

Instruction Manual



Provided by

MyBinding.com
When Image Matters.

Call Us at 1-800-944-4573

Loading Staples:

1. Open staple magazine by depressing magazine release button located on the top of the stapler, just behind the handle.
2. Load staples into the magazine.
Use only BOSTITCH SB38HD staples.
3. Close magazine until audible "click" is heard.

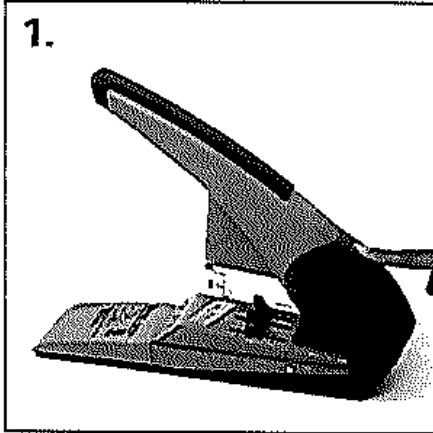

Open Magazine

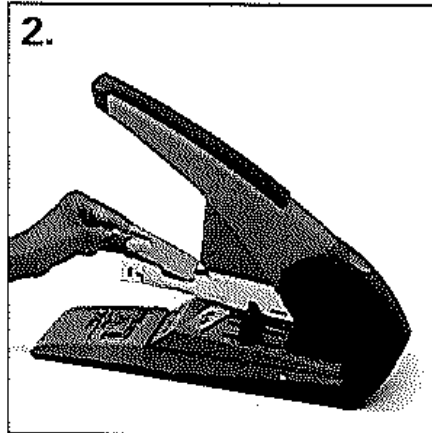

Load Staples

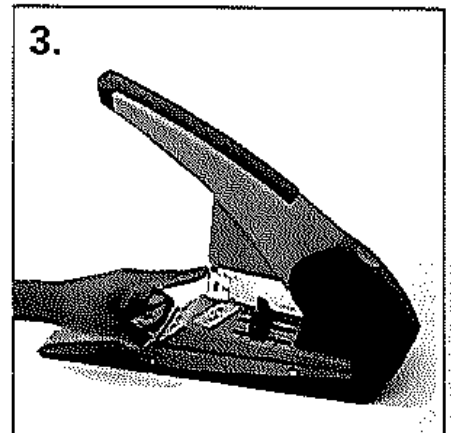

Close Magazine

Adjusting Paper Guide:

1. Unlock the paper guide by first pressing the release button on the right side of the paper guide.
2. Adjust the paper guide by sliding forwards or backwards.
3. Lock the paper guide by pressing the lock button on the left side of the paper guide.

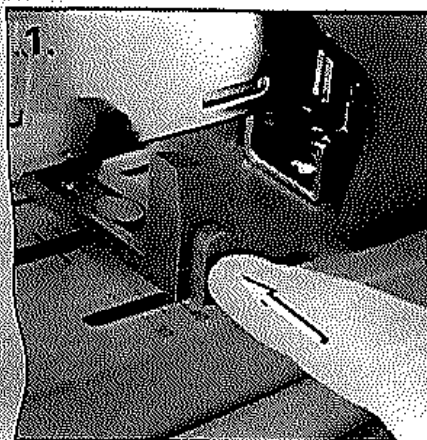

Unlock Guide

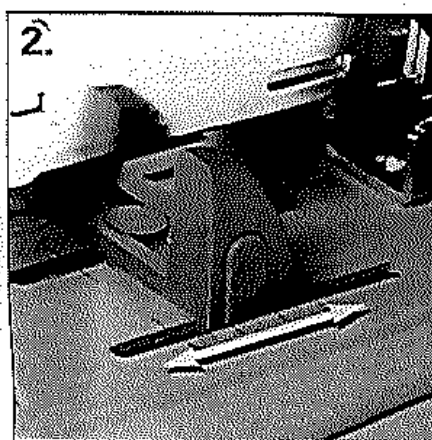

Adjust

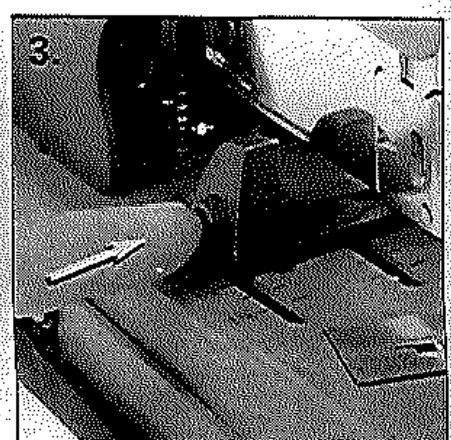

Lock Guide

Stapling:

The BOSTITCH B380HD Extra Heavy Duty Stapler features a unique design that allows the stapling of 2 – 180 sheets of 20lb paper with only one size staple (BOSTITCH SB38HD). This unique design trims the staple to the appropriate length depending on the number of sheets being stapled. Please follow the instructions below to ensure optimum performance.

1. Position papers against paper guide.
2. Depress the handle fully. As the handle is depressed fully, the clinching anvil will drop into the base of the unit, trimming the staple to size and clinching the staple.
Note: failure to depress the handle fully may result in a easily cleared staple jam.
3. Release the handle.

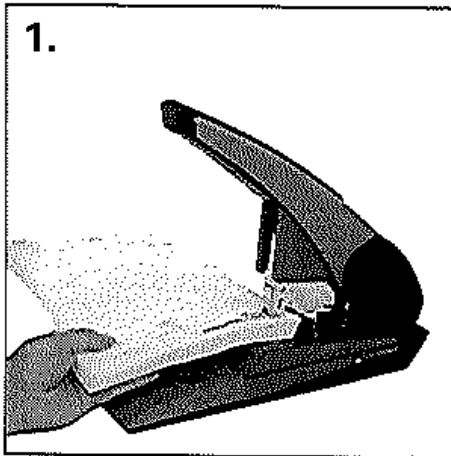

Position Papers

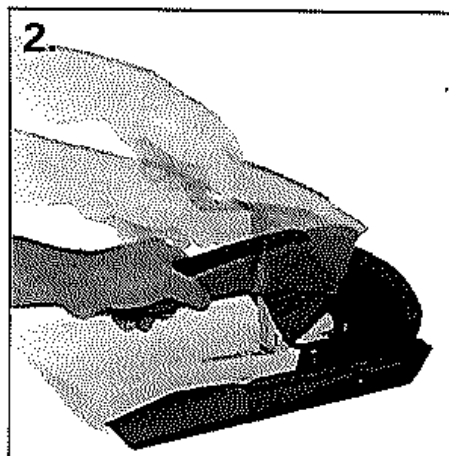

Depress Handle Fully

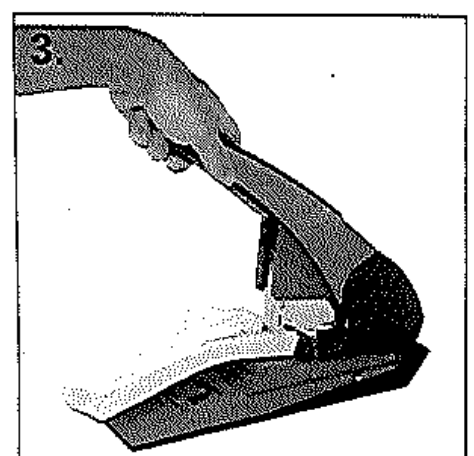

Release Handle

Staple Jam Clearing:

1. Leave the papers in place.
2. Open the magazine, unload staples, close magazine.
3. Repeat the staple operation (with papers in place), ensuring that the handle is fully depressed.
4. Remove the papers and check to see if the staple has been clinched. If not, re-staple the papers, ensuring that the handle is fully depressed.

Emptying Staple Trimming Receptacle:

The BOSTITCH B380HD Extra heavy duty Stapler captures the staple trimmings in the base of the stapler. These trimmings should be emptied every new box of staples.

1. Position stapler over waste basket and remove the trimming receptacle cover.
2. Empty trimmings into waste basket.
3. Replace trimming receptacle cover.

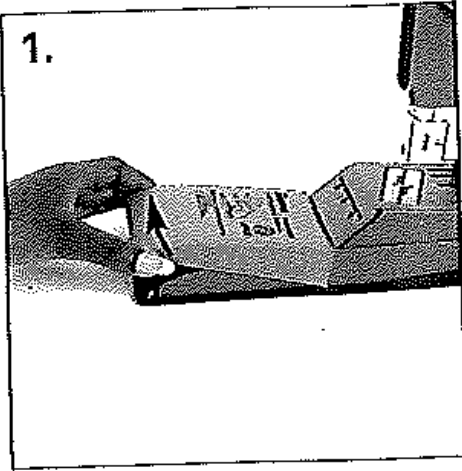

Remove Cover

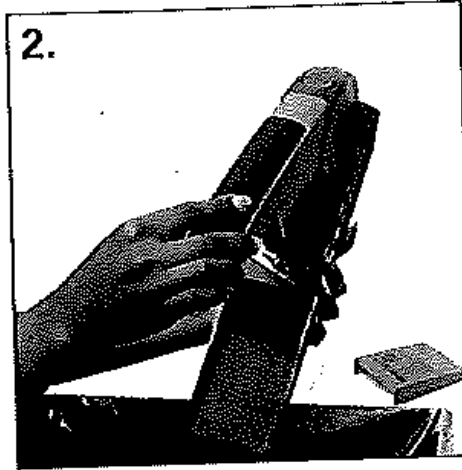

Empty Staple Trimmings

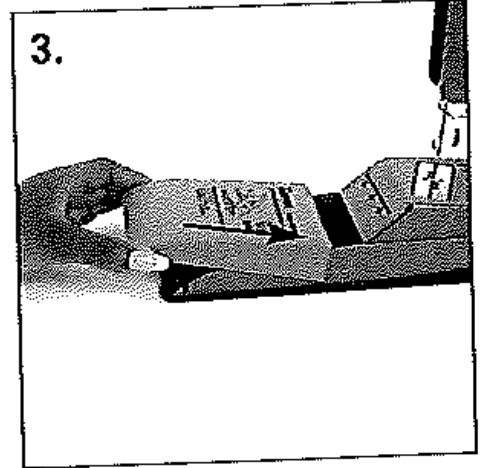

Replace Cover

Accessories:

SB38HD-1M	Extra Heavy Duty Staples - 1000 ct
SB38HD-5M	Extra Heavy Duty Staples - 5000 ct